

Quic-Lock Upper Pull Release Installation Manual

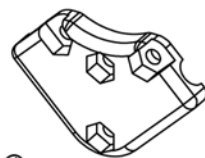

1-800-711-FIRE - www.ziamatic.com

QLM-U-USM Parts List

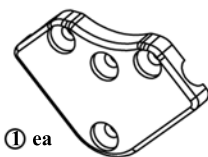
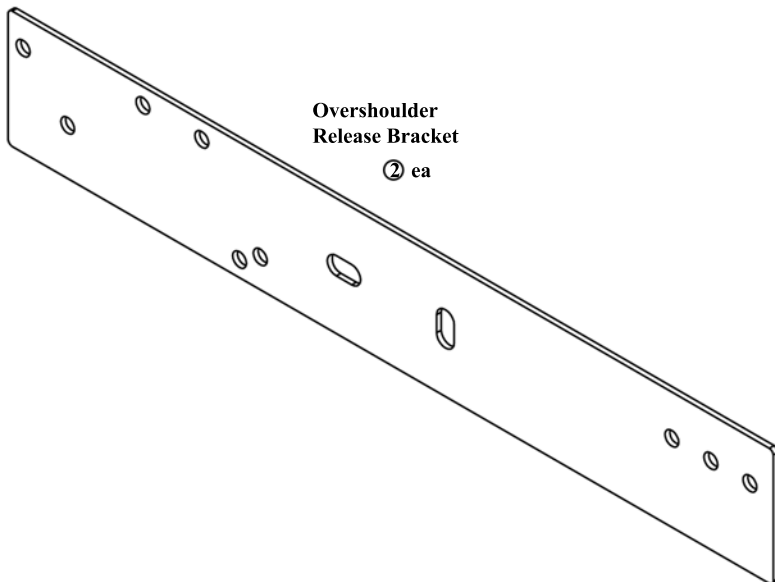
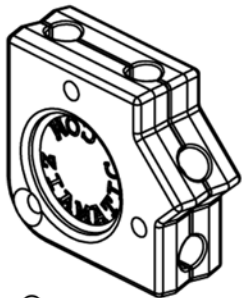
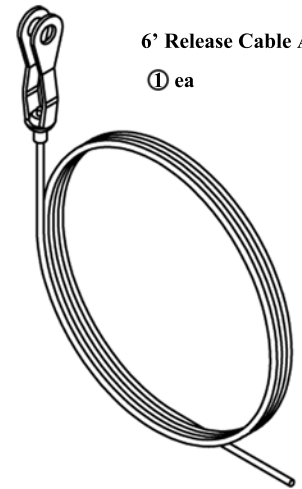
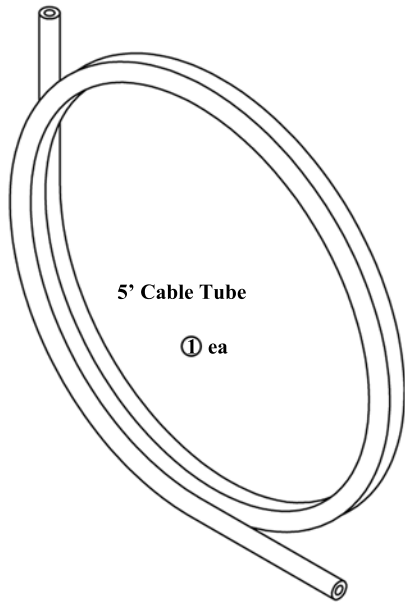

- ④ Wire Tie
- ② 10-32 Jam nut
- ② 10-32 x 1" long Flat Head Screw
- ② 10-32 x 5/8 long Flat Head Screw
- ② Lockwasher 1/4
- ④ Plain Washer 1/4
- ② 1/4-20 Self-Locking Nut
- ④ 1/4-20 x 3/4 Long Hex Head Bolt
- ② 10-32 x 1-1/4 Long Pan Head Screw
- ④ 10-32 Self-Locking Nut
- ① Clevis Pin 3/16 x 1/2 Long
- ① Hair Pin Cotter Pin
- ① Plain Washer #10
- ① Yellow Knob
- ① Stop Sleeve
- ① 8-32 Set Screw

Left Hand Side

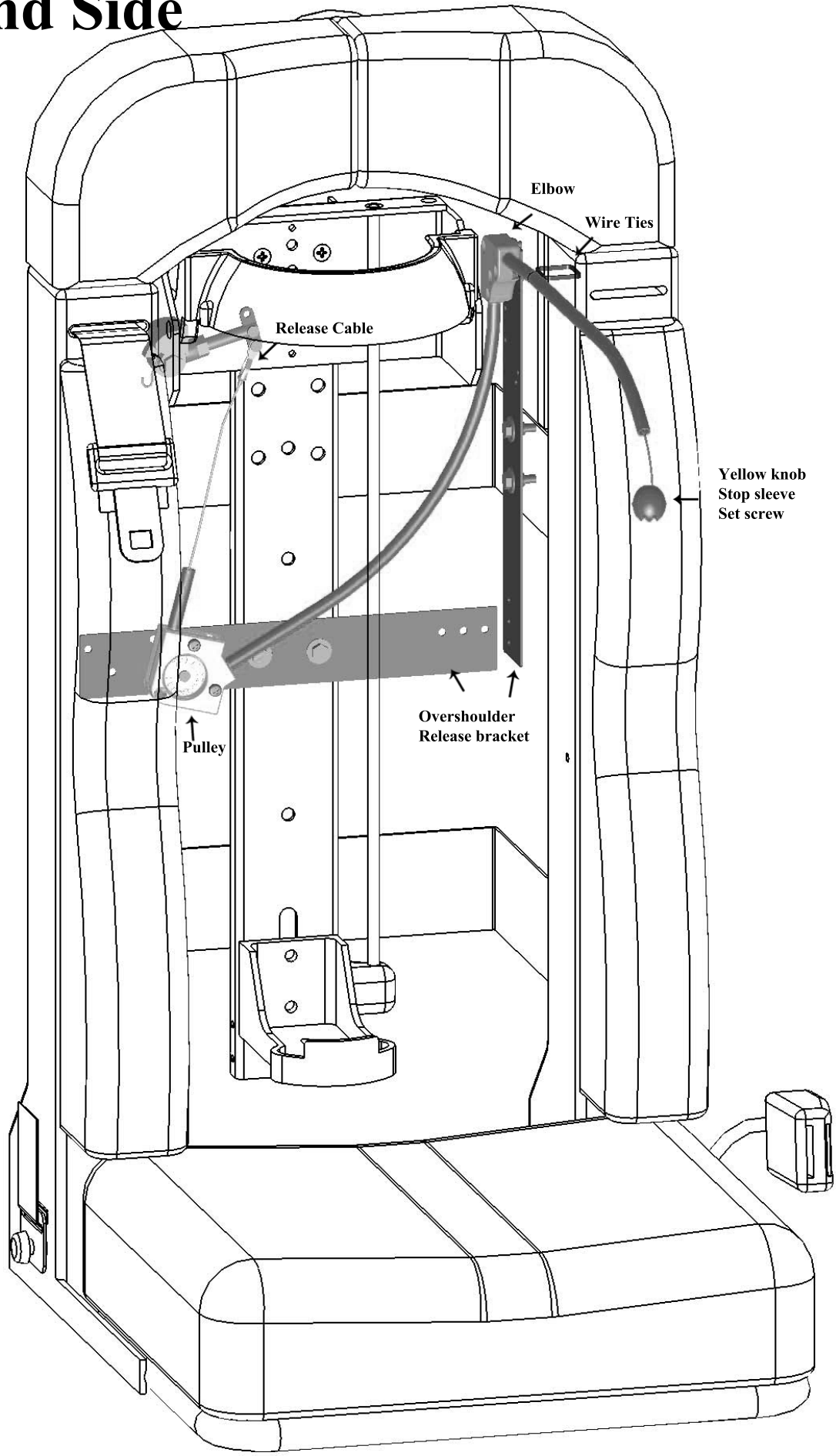

Left Hand Side

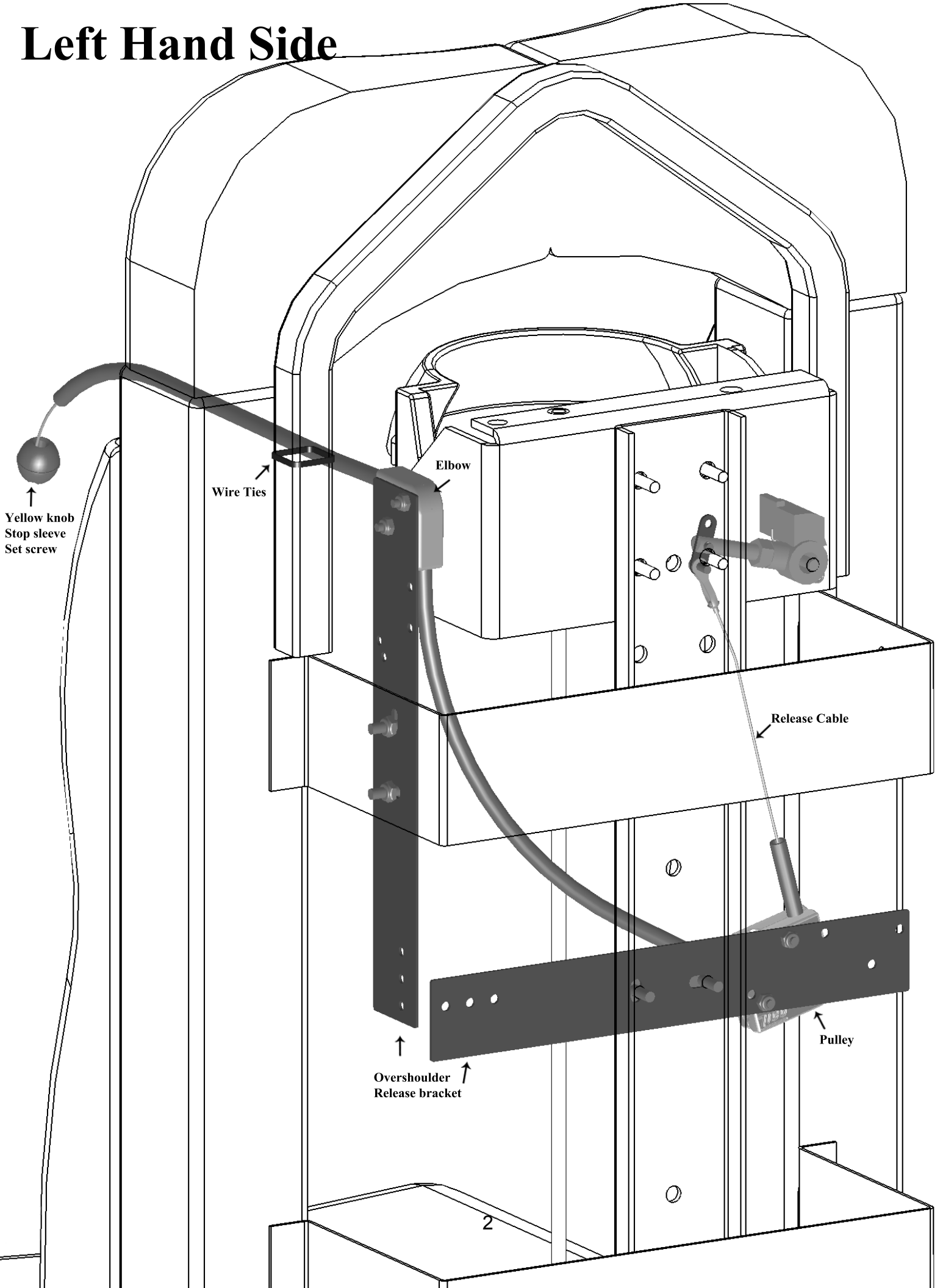

Quic-Lock Upper Seat Pull Release Installation Manual Model: QLM-U-USM

Tools:

- Phillips Head Screwdriver (#2 Tip preferred)
- 3/8 open end wrench
- 6" adjustable wrench
- cable cutter or wire cutter
- 1/4 open end wrench
- tape measure
- hand drill with 9/32 drill bit or unibit
- 5/64 Allen wrench

The following instructions are for installation on the left hand side. If installing on the right hand side start on page 13.

1. Before installing the QLMU-USM, please make sure that you have followed the instructions for properly setting up and mounting your QLM-U Quic-Lock Bracket.
2. Adjust your seat brackets to the optimal position for the back of your airpack to be flush with the back of your seat or to your desired fit.
3. If you are upgrading a QLM-U you must first remove the release assembly bracket along with the cable release assembly. This can be done by removing the (2) 1/4-20 x 3/4 Hex head screws on bracket and detaching the release cable from the cam rod by removing the cotter and clevis pin.

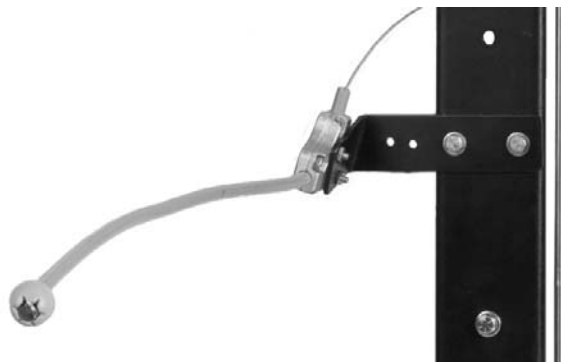

4. Install Pulley to one the Overshoulder Release Brackets using (2) 10-32 x 1-1/4" long Phillips head screws and (2) 10-32 self-locking nuts. Leave screws loose at this time. Install the Overshoulder Release Bracket to the QLM-U backplate using (2) 1/4-20 x 3/4" long hex head screw, (2) 1/4 lock washers, and (2) plain washers.

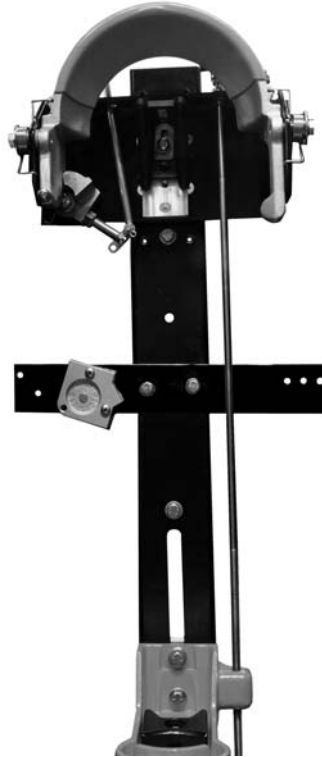

5. Clamp together two halves of the Elbow at about the center of the yellow tubing, Use (2) 10-32 x 5/8" long flat head screws and 10-32 jam nuts in the holes shown below. *(Tubing will be trimmed later to position the release cable to your ideal location.)*



6. Mount Elbow and second OverShoulder Release Bracket with hex side facing bracket using (2) 10-32 x 1-1/4" long Phillips Head Screws and (2) 10-32 self-locking nuts. Tighten all 10-32 screws on the Elbow at this time.



7. Locate intended position for OverShoulder Release Bracket and drill (2) mounting holes that are $9/32\varnothing$, as shown below, 1-1/2" apart on the upper left side of the seat shroud with the bracket facing the middle of the seat. **PLEASE NOTE: It is important to try to keep the curvature of the tubing as gradual as possible between the Pulley and the Elbow. To ensure this, it is recommended to clamp the bracket in place to determine hole placement before drilling.** Once holes are drilled, install bracket with Elbow to the Seat using (2) 1/4-20 x 3/4 HH, (2) 1/4-20 locknuts and (2) 1/4-20 flat washers.



8. Loosely wrap one Wire Tie around tubing extending over the shoulder. Wrap a second wire tie through the first wire tie and around a support location on the seat (most likely somewhere near the headrest of the seat). Tighten and trim both wire ties.



9. Take end of the tubing extending downward out of the Elbow and hold it up; against the angled exit point on the Pulley (Make sure tubing is run behind the adjustment rod of the QLM-U, not in front of it). Cut the tubing $7/16$ " past the edge of the Pulley.

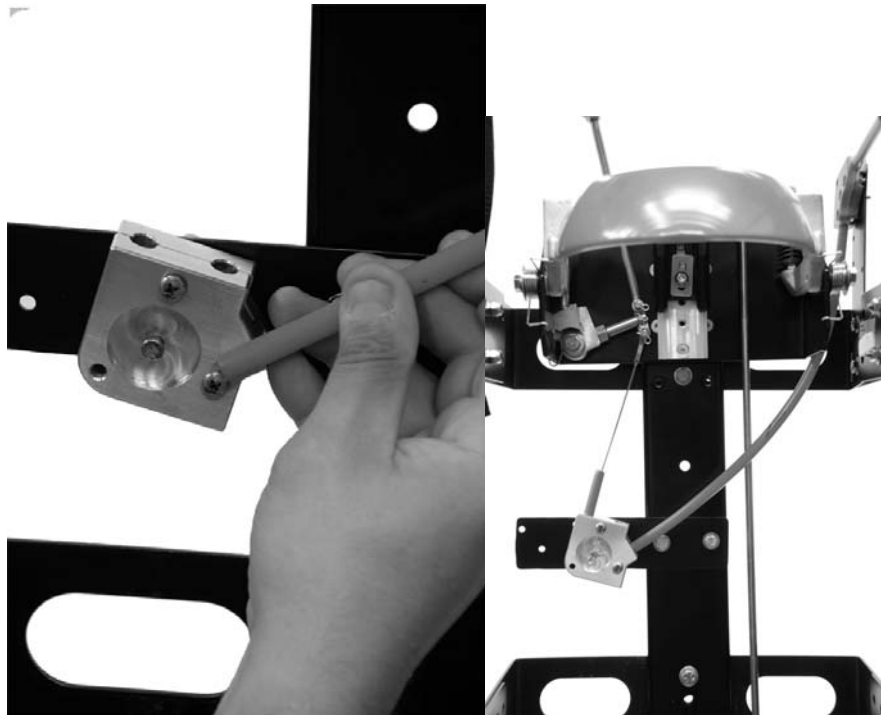

10. Now sit in the seat. Reach up for pull release and mark the ideal location for pull release knob. Cut the tubing at this preferred location.



11. Assemble cable to the QLM-U cam using a 3/16 x 1/2" long clevis pin, a hairpin, and a #10 plain washer.



12. Cut a 2" piece of tubing and slide it over the cable.
13. Feed the cable around Pulley, with 2" tubing above pulley, exiting at the angled location. (*Bottom 10/32 x 1-1/4 screw will need to be removed to feed cable through pulley correctly. If getting the cable in the proper position proves to be difficult the Pulley can be disassembled*). Feed the cable through the remaining length tubing (if the end of the cable is frayed, trim it first). Position both pieces of tubing into place on Pulley as shown below and tighten screws. CAUTION: Be sure not to pinch the cable.



14. Make sure the top clamp is in LOCK position and cam is in the FULL LOCK position.

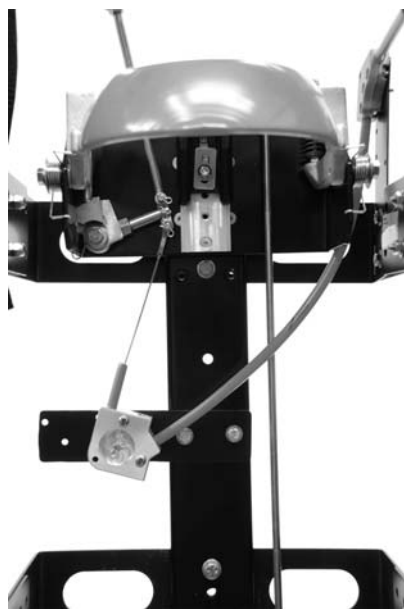

15. Slide the Yellow Knob over the Cable up to the end of the Yellow Tube.

16. Slide the Stop Sleeve over the Cable with the tapered end of the Stop Sleeve facing the Knob.



17. Cut the Cable close to the Stop Sleeve. Pull the Cable back until it is flush with the face of the Stop Sleeve.



18. Firmly tighten set screw in stop sleeve with 5/64 Allen Wrench.

19. Push the Stop Sleeve into the Knob.

Your QLM-U-USM is now installed. Please read all operational instructions before operating this product.

Right Hand Side

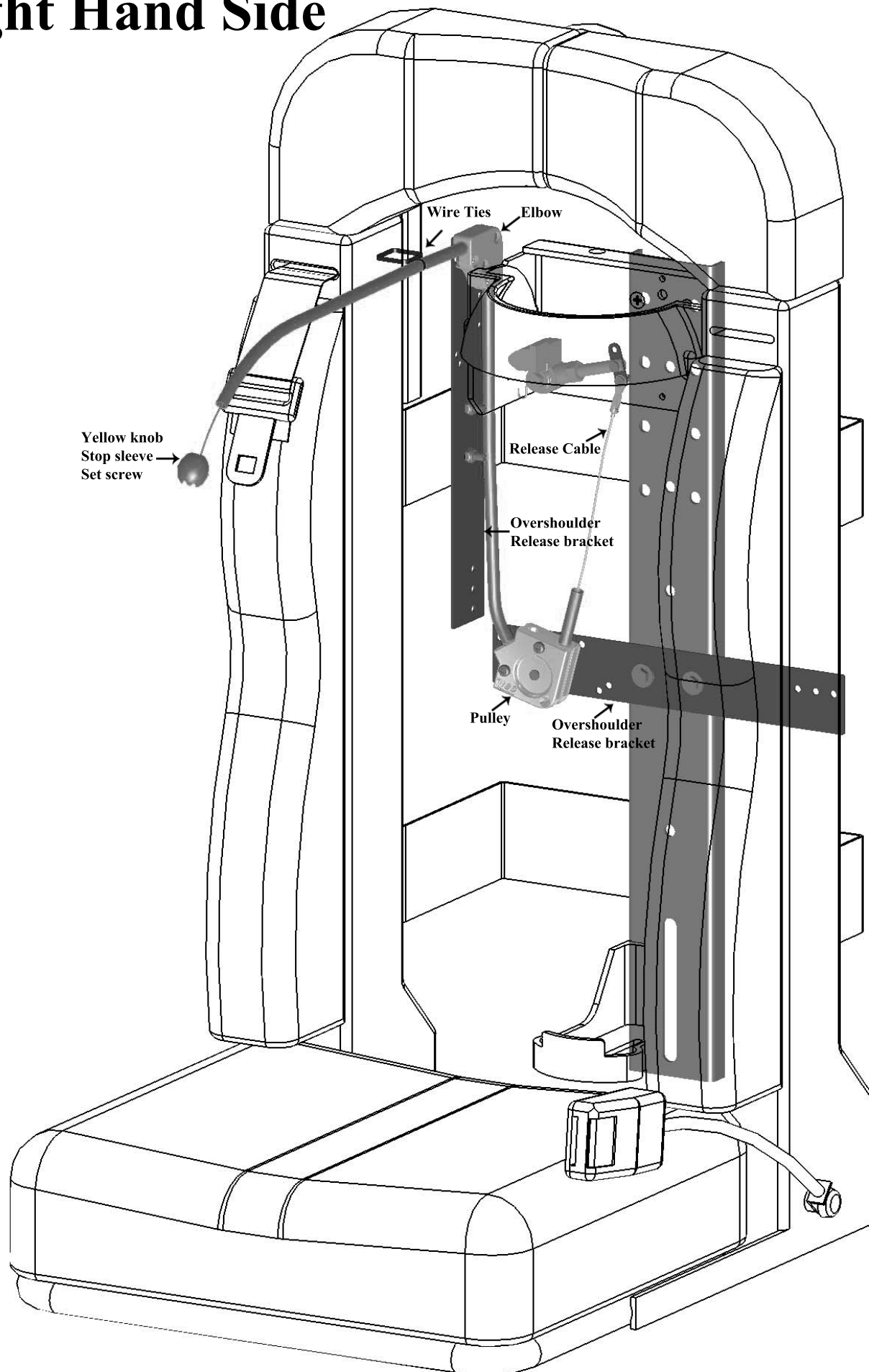

Right Hand Side

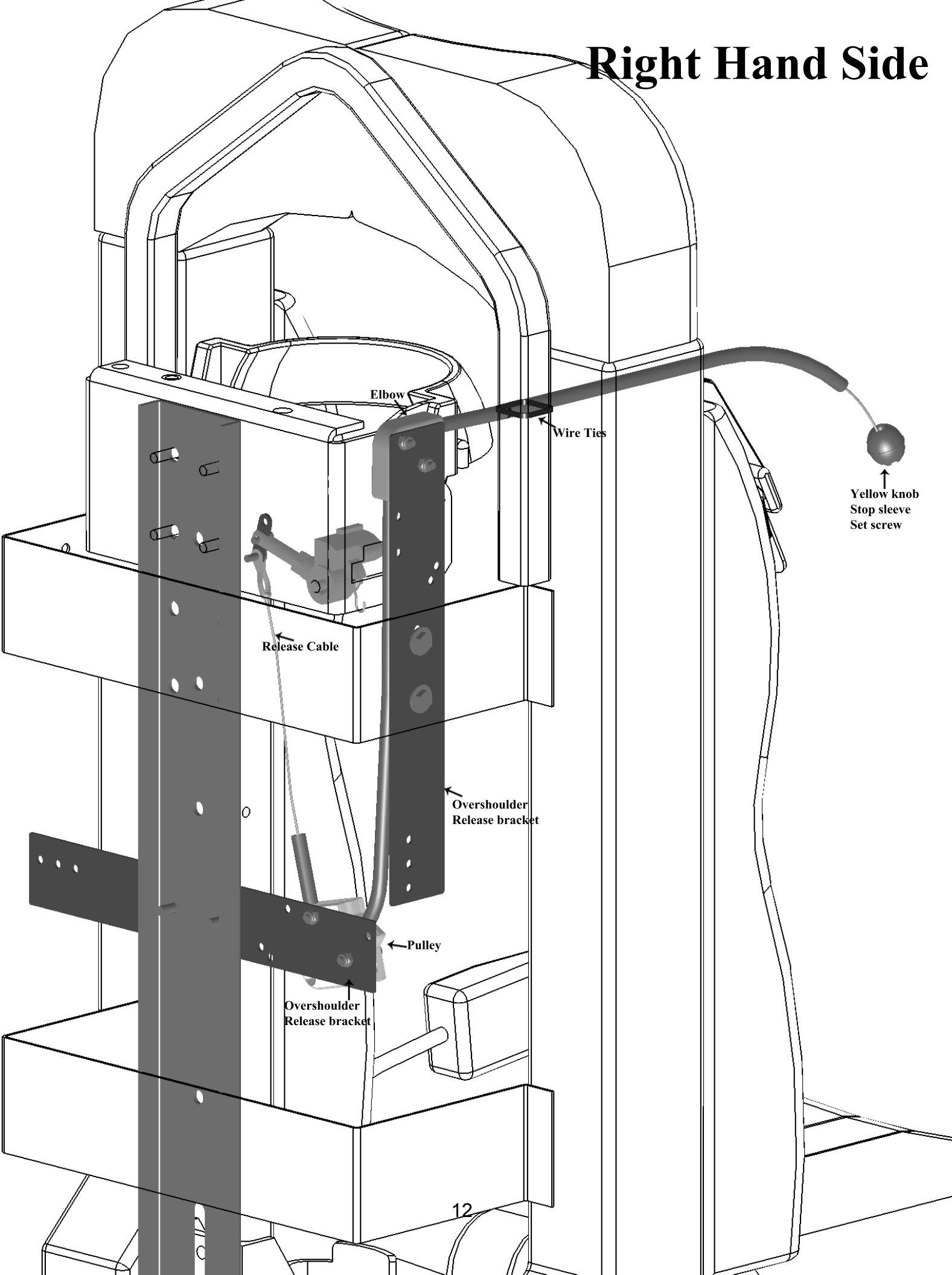

The following instructions are for installation on the right hand side. If installing on the left hand side start on page 3.

1. Before installing the QLMU-USM, please make sure that you have followed the instructions for properly setting up and mounting your QLM-U Quic-Lock Bracket.
2. Adjust your seat brackets to the optimal position for the back of your airpack to be flush with the back of your seat or to your desired fit.
3. If you are upgrading a QLM-U you must first remove the release assembly bracket along with the cable release assembly. This can be done by removing the (2) ¼-20 x ¾ Hex head screws on bracket and detaching the release cable from the cam rod by removing the cotter and clevis pin.

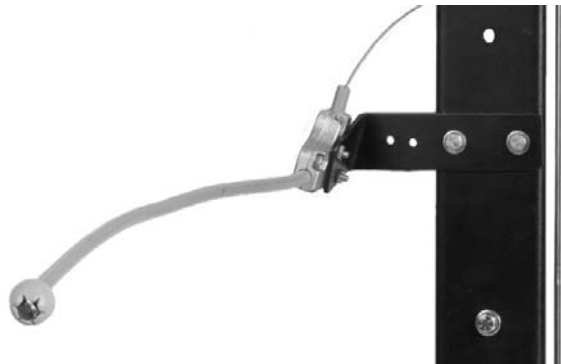

4. Install Pulley to one the Overshoulder Release Brackets using (2) 10-32 x 1-1/4" long Phillips head screws and (2) 10-32 self-locking nuts. Leave screws loose at this time. Install the Overshoulder Release Bracket to the QLM-U backplate using (2) ¼-20 x 3/4" long hex head screw, (2) ¼ lock washers, and (2) plain washers.



5. Clamp together two halves of the Elbow at about the center of the yellow tubing, Use (2) 10-32 x 5/8" long flat head screws and 10-32 jam nuts in the holes shown below. (*Tubing will be trimmed later to position the release cable to your ideal location.*) Leave screws loose at this time.

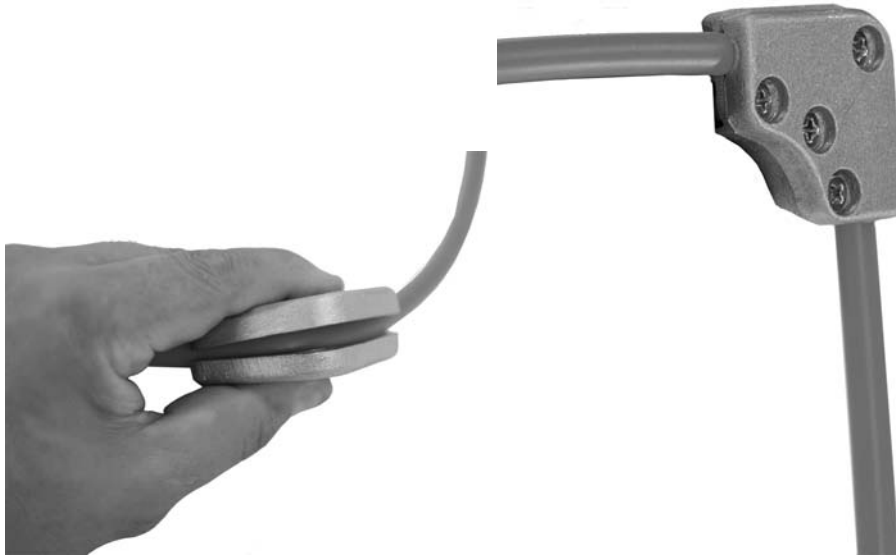

6. Mount Elbow and second OverShoulder Release Bracket with hex side facing bracket using (2) 10-32 x 1-1/4" long Phillips Head Screws and (2) 10-32 self-locking nuts. Tighten all 10-32 screws on the Elbow at this time.



7. Locate intended position for OverShoulder Release Bracket and drill (2) mounting holes that are $9/32\varnothing$, as shown below, 1-1/2" apart on the upper left side of the seat shroud with the bracket facing the middle of the seat. **PLEASE NOTE: It is important to try to keep the curvature of the tubing as gradual as possible between the Pulley and the Elbow. To ensure this, it is recommended to clamp the bracket in place to determine hole placement before drilling.** Once holes are drilled, install bracket with Elbow to the Seat using (2) $1/4$ -20 x $3/4$ HH, (2) $1/4$ -20 locknuts and (2) $1/4$ -20 flat washers.

8. Loosely wrap one Wire Tie around tubing extending over the shoulder. Wrap a second wire tie through the first wire tie and around a support location on the seat (most likely somewhere near the headrest of the seat). Tighten and trim both wire ties.



9. Take end of the tubing extending downward out of the Elbow and hold it up; against the angled exit point on the Pulley (Make sure tubing is run behind the adjustment rod of the QLM-U, not in front of it). Cut the tubing 7/16" past the edge of the Pulley.



10. Now sit in the seat. Reach up for pull release and mark the ideal location for pull release knob. Cut the tubing at this preferred location.



11. Assemble cable to the QLM-U cam using a 3/16 x 1/2" long clevis pin, a hairpin, and a #10 plain washer.



12. Cut a 2" piece of tubing and slide it over the cable.
13. Feed the cable around Pulley, with 2" tubing above pulley, exiting at the angled location. (*Bottom 10/32 x 1-1/4 screw will need to be removed to feed cable through pulley correctly. If getting the cable in the proper position proves to be difficult the Pulley can be disassembled*). Feed the cable through the remaining length tubing (if the end of the cable is frayed, trim it first). Position both pieces of tubing into place on Pulley as shown below and tighten screws. CAUTION: Be sure not to pinch the cable.

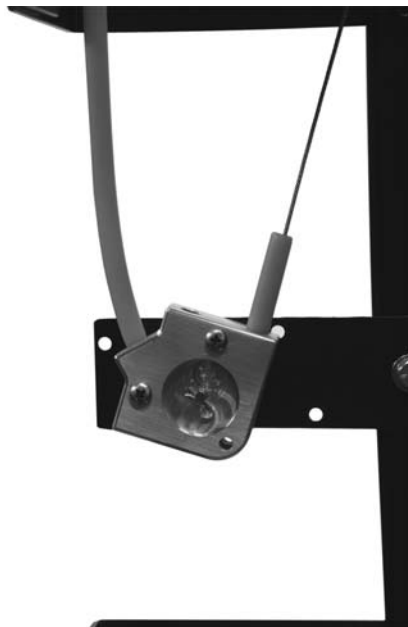

14. Make sure the top clamp is in LOCK position and cam is in the FULL LOCK position.

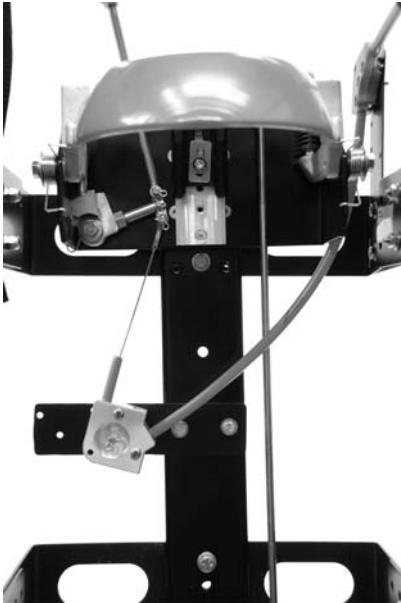

15. Slide the Yellow Knob over the Cable up to the end of the Yellow Tube.

16. Slide the Stop Sleeve over the Cable with the tapered end of the Stop Sleeve facing the Knob.



17. Cut the Cable close to the Stop Sleeve. Pull the Cable back until it is flush with the face of the Stop Sleeve.



18. Firmly tighten set screw in stop sleeve with 5/64 Allen Wrench.

19. Push the Stop Sleeve into the Knob.

Your QLM-U-USM is now installed. Please read all operational instructions before operating this product.