

# QUIC-HOLD® MECHANICAL BRACKET



The **Positive Locking** Mechanical WALKAWAY bracket meets **NFPA 1901-03 9G dynamic requirements for cylinder restraint system** for use in crew compartments. **Third party tested to 10G.**

Holds any self-contained breathing apparatus so it's ready to use. Its four PVC coated clamping arms securely lock the SCBA in place without damaging cylinder wall.

The basic bracket and clamp arms are made of strong, yet light-weight, aluminum alloys. Hex arms and operating lever are plated steel to withstand years of constant use.

Donning SCBA is fast and easy. Firefighter simply slips into the harness, pulls up on the cam-operated release lever, and is ready to go. A cable release mechanism is available for the mechanical bracket when used in our CBR seat.

Pat. No's. 4,586,687 - 5,354,029, D347,735  
UK 2,275,963, JA158519/93 & other  
Pat. Pending

Bracket dimensions: 23-3/8" L x 11" W x 7-3/8" D  
Optional MWAB-PR strap adds 4" to length

**NOTE: Not to be used in place of a seat belt when used with SCBA harness.**

Standard Mechanical Walkaway Brackets are available for use with the following air cylinders and will accommodate the optional MWAB-PR strap (see page 1-19).

MODEL	DESCRIPTION	WT./@ IN LBS.
MWAB-03-5	Use with 5.30" to 5.96" diameter cylinder	15.2
MWAB-03-6	Use with 5.97" to 6.62" diameter cylinder	15.6
MWAB-03-7	Use with 6.63" to 7.30" diameter cylinder	16.0
1045-000-175	Replacement clamp arm for MWAB-03-5, stamped 5-5/3	.5
1045-000-155	Replacement clamp arm for MWAB-03-6, stamped 6-5/3	.5
1045-000-105	Replacement clamp arm for MWAB-03-7, stamped 7-5/3	.6

For different cylinder diameters, the clamp arms are easily changed to accommodate the new cylinder. Priced per each, 4 required for bracket.

# QUIC-HOLD® MODEL MWAB-03-\_\_ BRACKETS

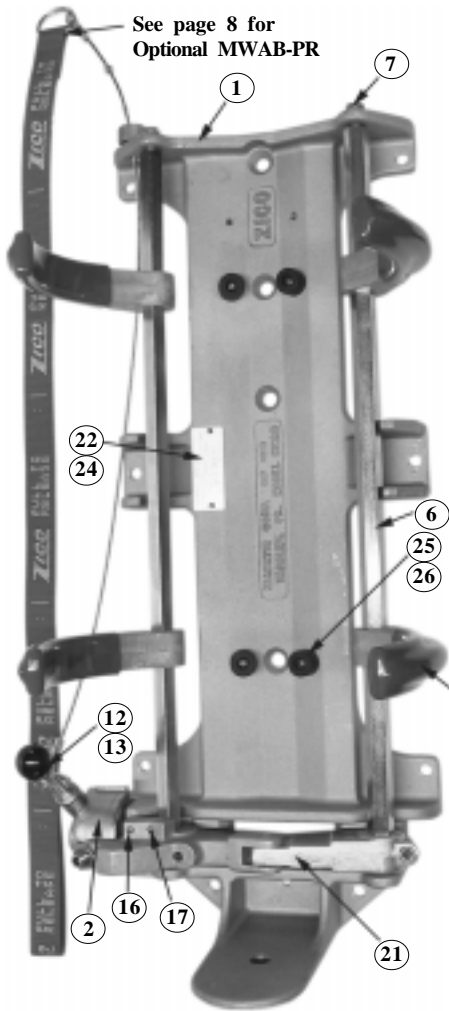

ITEMNO.	PARTNUMBER	DESCRIPTION			
			MWAB-03-5	MWAB-03-6	MWAB-03-7
1	1045-000-101	Base casting with foot - alum NEW	1	1	1
2	1045-000-102	Cam casting - steel	1	1	1
3	1045-109-103	Cam follower pivot arm - alum		1	1
4	1045-120-104	Pivot arm casting - alum	1	1	1
5	1045-000-175	Clamp arm casting - 5" NEW	4		
	1045-000-155	Clamp arm casting - 6" NEW		4	
	1045-000-105	Clamp arm casting - 7" NEW			4
6	1045-000-106	Pivot beam - 5/8" hex steel	2	2	2
7	1045-000-107	Shoulder bolt - steel	2	2	2
10	1045-000-110	Compression spring	1	1	1
11	1045-000-111	Torsion spring	1	1	1
12	1045-120-116	Cam stud 3/8 x 3 with .120 hole	1	1	1
13	1045-120-113	Ball knob - metric	1	1	1
14	1045-000-128	Washer .72 OD x .463 ID x .104	2	2	2
15	1045-120-190	M6 x 1 g x 16mm sock hd screw	5	5	5
16	1045-120-192	M6 x 1 g x 22mm sock set screw	1	1	1
17	1045-120-194	M6 x 1 g x 12mm sock set screw	1	1	1
18	1045-120-196	M10 x 6g x 35mm fl pt soc ss	1	1	1
19	1045-120-198	M10 x 6h hex hd nut	1	1	1
20	9045-103736	Pin 3/8 x 2-1/4"	1	1	1
21	9045-103116	Pin 5/16 x 1	1	1	1
22	1045-000-131	Label - metal - patent no.	1	1	1
24	9020-100803	Drive screw #2 x 3/16" type U	2	2	2
25	1045-260-113	Rubber bumper	4	4	4
26*	9010-242008	Screw 10-32 x 1/2 rd hd phillips	4	4	4
29	1045PM6	Parts and instruction sheet	1	1	1

\*Presently using 8-32 x 1/2 screw but changing to 10-32.

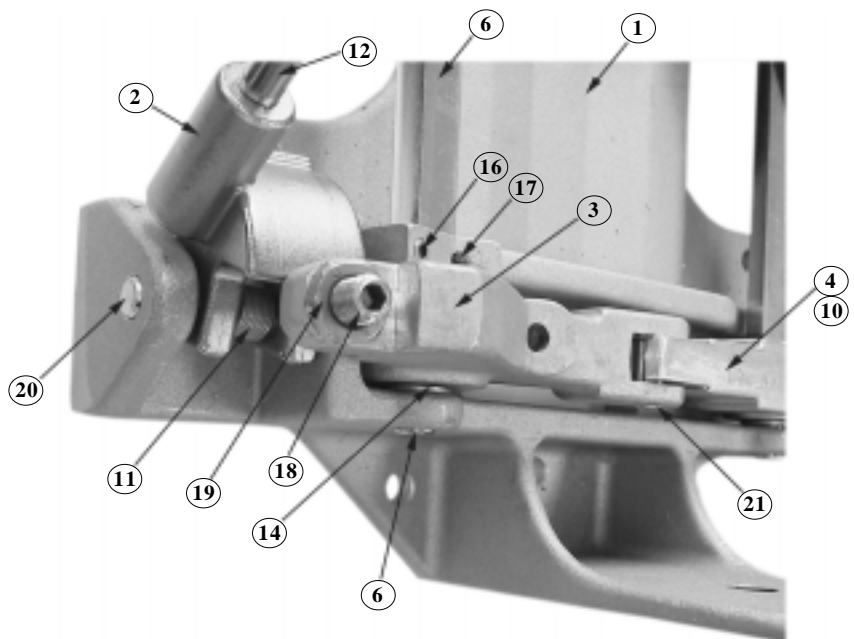

# QUIC-HOLD® MODEL MWAB-\_\_-SP BRACKETS

Specially designed Mechanical Walkaway Brackets lack the normal metal footplate. They are designed to be used "upside-down" in SCBA seating. The air cylinder rests upon our Model NSF short footplate. Brackets come standard with a nylon pull release strap.

MODEL	DESCRIPTION	WT./@ IN LBS.
MWAB-5-D-SP	Use with 5.3" to 6.1" diameter cylinder	13.5
MWAB-6-SP	Use with 6.7" to 6.9" diameter cylinder	14.0
MWAB-7-SP	Use with 7.1" to 7.3" diameter cylinder	14.0
1045-107-177	Replacement clamp arm for MWAB-5-D-SP, stamped 5.5	.3
1045-120-155	Replacement clamp arm for MWAB-6-SP, stamped 6 or 6.7	.4
1045-000-105	Replacement clamp arm for MWAB-7-SP, stamped 7 or 7.0	.5

For different cylinder diameters, the clamp arms are easily changed to accommodate the new cylinder. \*Priced per each, 4 required for bracket.

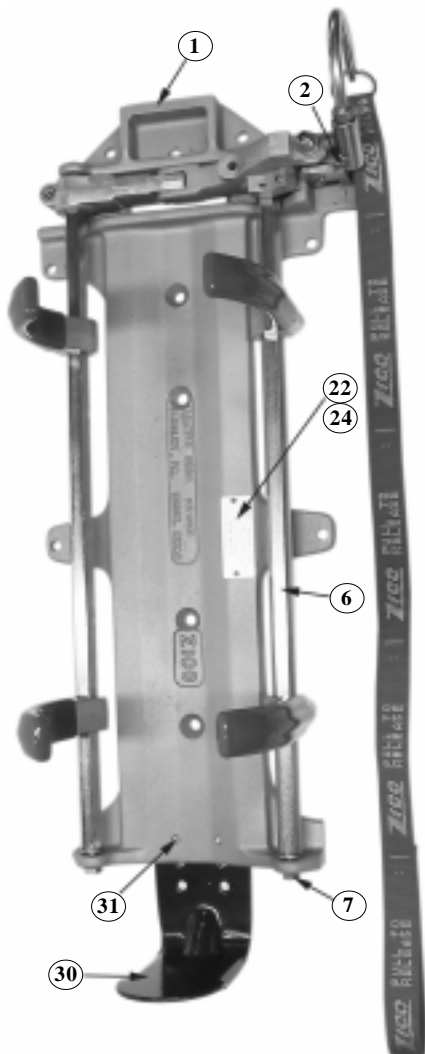

ITEMNO.	PARTNUMBER	DESCRIPTION	MWAB-5-D-SP	MWAB-6-SP	MWAB-7-SP
1	1045-225-101	Base casting - no mounting tabs	1	1	1
2	1045-000-102	Cam casting - steel	1	1	1
3	1045-109-103	Cam follower pivot arm - alum	1	1	1
4	1045-120-104	Pivot arm casting - alum	1	1	1
5	1045-120-155	Clamp arm casting - 6" OLD		4	
	1045-000-105	Clamp arm casting - 7" OLD			4
	1045-107-177	Clamp arm casting - 5-D' OLD	4		
6	1045-000-106	Pivot beam - 5/8" hex steel	2	2	2
7	1045-000-107	Shoulder bolt - steel	2	2	2
10	1045-000-110	Compression spring	1	1	1
11	1045-000-111	Torsion spring	1	1	1
12	1045-225-116	Actuating handle	1	1	1
13	1045-225-113	Pull strap - 30" L	1	1	1
14	1045-000-128	Washer .72 OD x .463 ID x .104	2	2	2
15	1045-120-190	M6 x 1g x 16mm sock hd screw	5	5	5
16	1045-120-192	M6 x 1g x 22mm sock set screw	NS	1	1
17	1045-120-194	M6 x 1g x 12mm sock set screw	NS	1	1
18	1045-120-196	M10 x 6g x 35mm fl pt soc ss	1	1	1
19	1045-120-198	M10 x 6h hex hd nut	1	1	1
20	9045-103736	Pin 3/8 x 2-1/4"	NS	1	1
21	9045-103116	Pin 5/16 x 1	1	1	1
22	1045-000-136	Label - metal - patent no.	1	1	1
24	9020-100803	Drive screw #2 x 3/16" type U	2	2	2
29	1045PM6	Parts and instruction sheet	1	1	1
30	1010-020-105	NF footplate	1	1	1
31	9010-162509	1/4-20 x 9/16 fl hd phillips M/S	2	2	2
32	9012-103700	3/8-16 hex hd finishing nut	2	2	2

NS = Not shown this page

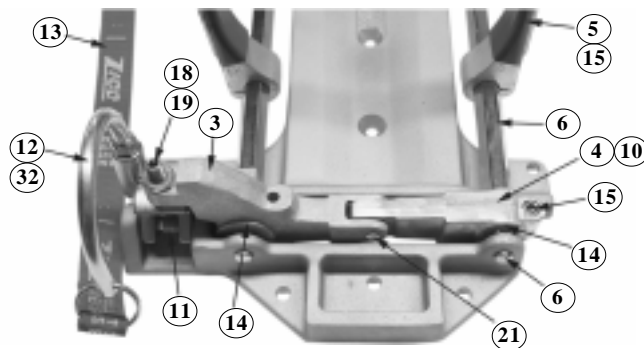

# QUIC-HOLD® MODEL MWAB-7-SC-50 BRACKET

Designed specifically for the Scott Part Number 804255-01 full wrap Kevlar, 45-minute, 4500 PSI, air cylinder.

Utilizes two new 7" clamp arms on bottom and tapered arms on top which conform to the shape of the cylinder. Will not work with cylinder and valve assembly length greater than 22" long.

MODEL	DESCRIPTION	WT./@ IN LBS.
MWAB-7-SC-50	Mechanical bracket	14.5
1045-000-105	Replacement 7" arm, stamped 7-5/3	.5
1045-122-105	Top left clamp arm, stamped 6.7R	.5
1045-122-110	Top right clamp arm, stamped 6.7L	.5

\*Model No. changed from "6" to "7" on 1-1-04.

MWAB-7-SC-50

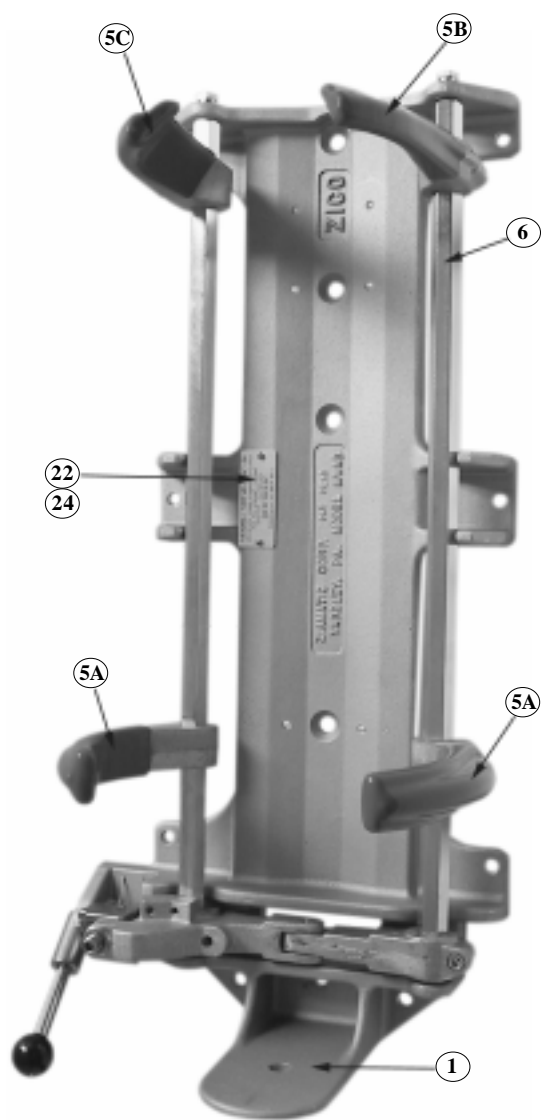

ITEMNO.	PARTNUMBER	DESCRIPTION		
1	1045-000-101	Base casting with foot - alum	NEW	1
2	1045-000-102	Cam casting - steel	NS	1
3	1045-109-103	Cam follower pivot arm - alum	NS	1
4	1045-120-104	Pivot arm casting - alum	NS	1
5A	1045-000-105	Clamp arm casting - 7" NEW		2
5B	1045-122-105	Clamp arm casting - special right		1
5C	1045-122-110	Clamp arm casting - special left		1
6	1045-000-106	Pivot beam - 5/8" hex steel		2
7	1045-000-107	Shoulder bolt - steel		2
10	1045-000-110	Compression spring	NS	1
11	1045-000-111	Torsion spring	NS	1
12	1045-120-116	Cam stud 3/8 x 3 with .120 hole	NS	1
13	1045-120-113	Ball knob - metric	NS	1
14	1045-000-128	Washer .72 OD x .463 ID x .104	NS	2
15	1045-120-190	M6 x 1 g x 16mm sock hd screw	NS	5
16	1045-120-192	M6 x 1 g x 22mm sock set screw	NS	1
17	1045-120-194	M6 x 1 g x 12mm sock set screw	NS	1
18	1045-120-196	M10 x 6g x 35mm fl pt soc ss	NS	1
19	1045-120-198	M10 x 6h hex hd nut	NS	1
20	9045-103736	Pin 3/8 x 2-1/4"	NS	1
21	9045-103116	Pin 5/16 x 1	NS	1
22	1045-000-136	Label - metal - patent no.		1
24	9020-100803	Drive screw #2 x 3/16" type U		2
29	1045PM6	Parts and instruction sheet		1

NS = Not shown this page



See page 2 for lower end parts

# QUIC-HOLD® MODEL MWAB-B-\_\_ BRACKETS

Specially designed Mechanical Walkaway Brackets lacking the normal metal footplate. A shelf or rest must be provided for the air cylinder valve assembly to rest upon.

MODEL	DESCRIPTION	WT./@ IN LBS.
MWAB-BD-5	Use with 5.3" to 6.1" diameter cylinder	13.5
MWAB-B-6	Use with 6.7" to 6.9" diameter cylinder	14.0
MWAB-B-7	Use with 7.1" to 7.3" diameter cylinder	14.0
1045-107-177	Replacement clamp arm for MWAB-BD-5, stamped 5.5	.3
1045-120-155	Replacement clamp arm for MWAB-B-6, stamped 6 or 6.7	.4
1045-000-105	Replacement clamp arm for MWAB-B-7, stamped 7 or 7.0	.5

For different cylinder diameters, the clamp arms are easily changed to accommodate the new cylinder. \*Priced per each, 4 required for bracket.

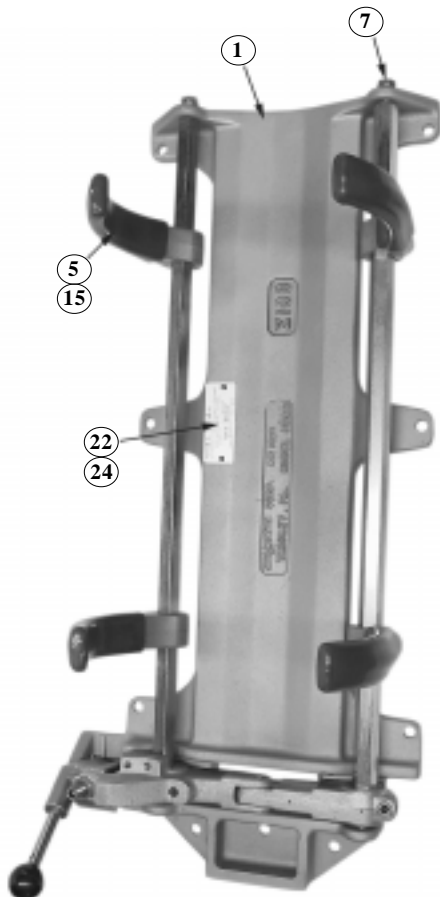

ITEMNO.	PARTNUMBER	DESCRIPTION	MWAB-BD-5	MWAB-B-6	MWAB-B-7
1	1045-226-101	Base casting - less foot plate	1	1	1
2	1045-000-102	Cam casting - steel	1	1	1
3	1045-109-103	Cam follower pivot arm - alum	1	1	1
4	1045-120-104	Pivot arm casting - alum.	1	1	1
5	1045-107-177	Clamp arm casting - 5 - D' OLD	4		
	1045-120-155	Clamp arm casting - 6" OLD		4	
	1045-000-105	Clamp arm casting - 7" OLD			4
6	1045-000-106	Pivot beam - 5/8" hex steel	2	2	2
7	1045-000-107	Shoulder bolt - steel	2	2	2
10	1045-000-110	Compression spring	1	1	1
11	1045-000-111	Torsion spring	NS	1	1
12	1045-120-116	Cam stud 3/8 x 3 with .120 hole	1	1	1
13	1045-120-113	Ball knob - metric	1	1	1
14	1045-000-128	Washer .72 OD x .463 ID x .104	2	2	2
15	1045-120-190	M6 x 1g x 16mm sock hd screw	5	5	5
16	1045-120-192	M6 x 1g x 22mm sock set screw	NS	1	1
17	1045-120-194	M6 x 1g x 12mm sock set screw	NS	1	1
18	1045-120-196	M10 x 6g x 35mm fl pt soc ss	1	1	1
19	1045-120-198	M10 x 6h hex hd nut	1	1	1
20	9045-103736	Pin 3/8 x 2-1/4"	NS	1	1
21	9045-103116	Pin 5/16 x 1	1	1	1
22	1045-000-136	Label - metal - patent no.	1	1	1
24	9020-100803	Drive screw #2 x 3/16" type U	2	2	2
29	1045PM6	Parts and instruction sheet	1	1	1

NS = Not shown this page

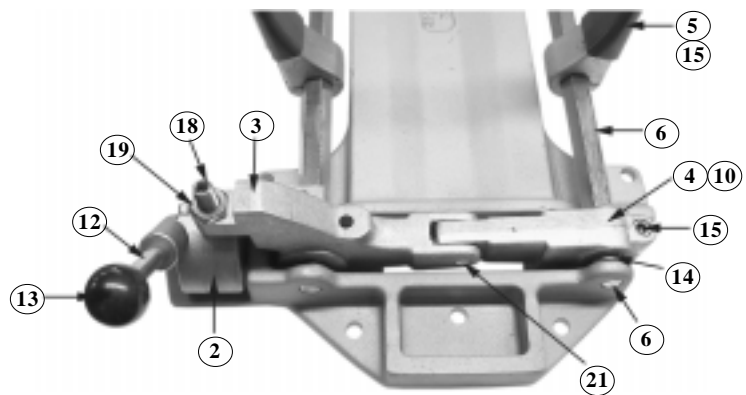

MODEL NO.	CLAMP ARM P/N	CLAMP ARM LENGTH (L")	CLAMP ARM STAMPED WITH NO.
MWAB-03-5	1045-000-175 NEW	4-9/16	5-5/3
MWAB-03-6	1045-000-155 NEW	5	6-5/3
MWAB-03-7	1045-000-105 NEW	5-9/16	7-5/3
MWAB-5-D-SB	1045-107-177 OLD	4-3/8	5.5
MWAB-6-SP	1045-120-155 OLD	5-3/16	6 or 6.7
MWAB-7-SP	1045-000-105 OLD	5-1/16	7 or 7.0
MWAB-6-SC-50	1045-120-155 OLD	5-3/16	6 or 6.7
	1045-122-105	5-1/2	6.7R (right side)
	1045-122-110	5-1/2	6.7L (left side)
MWAB-BD-5	1045-107-177 OLD	4-3/8	5.5
MWAB-B-6	1045-120-155 OLD	5-3/16	6 or 6.7
MWAB-B-7	1045-000-105 OLD	5-1/16	7 or 7.0

### Which Mechanical Bracket Do I Have?

The label attached to your bracket should identify the model you have or you may measure the length of the clamp arms to determine which model you have. You may require different clamp arms, depending upon the SCBA you are using. Refer to the charts on pages 11 through 13 to ascertain the model required. Then check pages 1 through 5 to see the difference in the various model numbers.

NOTE: Clamp arm casting is measured from the pivot beam to outside edge of the red PVC covering on the clamp arm. See drawing below.

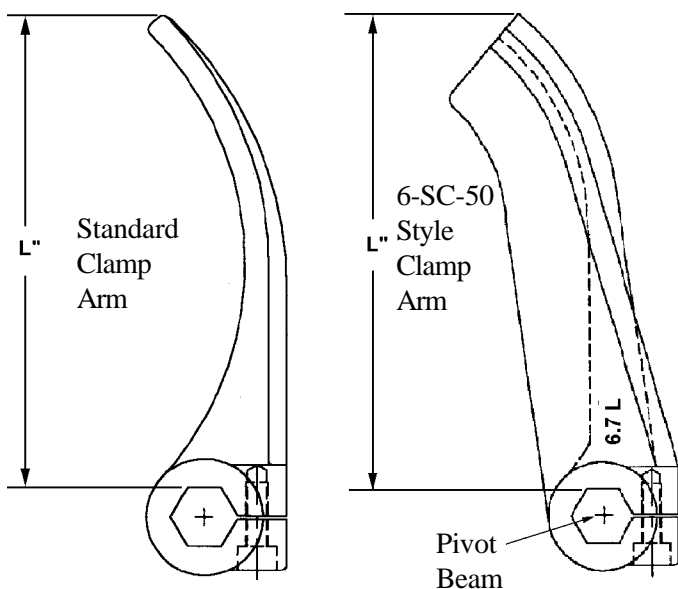

### Changing the Clamp Arms:

If the clamp arms are to be changed, we suggest the Mechanical bracket be removed from the seat (or wherever it is mounted) and laid on a flat bench. Then follow these steps to change the arms:

1. Push up on knob (13) on cam stud (12) to unlock cam (2).
2. Loosen clamp arms (5) that are presently on the bracket using 5 mm allen wrench on the socket head screws (15).
3. Remove two shoulder bolts (7) from end of pivot beams (6).
4. While holding pivot beams (6) so that the male end of the pivot beam cannot slide out of the base, carefully slide off present clamp arms, replace with new arms, and replace pivot beams (6).
5. Replace two shoulder bolts (7) and tighten down.
6. Swing cam lever (12) to unlocked position to make sure pivot beams (6) move freely and that pivot arm spring (10) is in place and working properly.
7. Make sure clamp arms are in proper position to grasp the air cylinder properly, while not interfering with the harness assembly or regulator. Tighten socket head clamp screws (15) on each clamp arm.
8. Adjust the socket set screw (16) so that when the air cylinder is lifted to a point where the center line of the air cylinder is touching the end of the two clamp arms on one side of the bracket and the end of the clamp arms on the opposite side are within 1/4 to 1/2" of the center line of the air cylinder on the opposite side.

A number may be stamped on the clamp arm casting, below the red PVC covering (see chart at top of page).

### To Obtain Correct Tension on the Air Cylinder

1. Open the cam (2) by lifting up on the ball knob (13).
2. Loosen lock nut (19) and back it off.
3. Turn in socket set screw (18) a few turns.
4. Place the air cylinder between clamp arms (5) and push in on clamp arms. Valve assembly, on the end of the air cylinder, should rest upon the foot plate of the base casting (1), or other firm surface if no foot plate.
5. Close clamp arms (5) by hand on the air cylinder and allow cam (2) to rotate downward. Allow the air cylinder to center itself.
6. Back out socket set screw (18) until the lip on top of the cam just aligns with the side of the pivot arm (4).
7. Tighten lock nut (19) and the adjustment is complete.
8. If the end of the pivot arm casting (4) strikes the air cylinder gauge when the clamp arms are open (as it may with the MSA 30-minute, 4500 PSI unit), then an NPM 3.5 nozzle post mount must be bolted to the foot plate.



**NPM 3.5 attached to foot plate.**  
See catalog details

### Mounting the Mechanical Bracket

You may disregard these instructions if your bracket came already mounted as part of a complete seat assembly. The bracket should be mounted so as to be at the proper height for donning while sitting in a comfortable position.

1. Select a mounting location. Any flat, stable surface will do.
2. Use the bracket as the template to mark mounting holes.

3. Use a 21/64" drill to drill the mounting holes using: any two of the holes down the center of the base casting where four holes are available.
4. Mount in place using 5/16" flat head bolts in the center holes.

### Donning Instructions

A departmental procedure should be established for the donning of SCBA enroute to an emergency. Donning procedure may be influenced by the type of seat belts being used.

1. Insert your arms into the harness assembly of the SCBA while moving into a sitting position. Snug up on the shoulder straps, but do not pull them tight.
2. Secure your seat belt per manufacturer's recommendation.\*\*
3. Hood and face mask may be donned while enroute to the emergency, per departmental policy.
4. Upon arrival on the emergency scene, the seat belt may be removed, per departmental procedure.
5. Lift up on the cam stud (12) which will move the clamp arms (5) apart, freeing the air cylinder.
6. Slide forward and prepare to exit the vehicle. Once outside the vehicle, final adjustments may be made to the SCBA straps and the face mask may be attached to the regulator.

### Re-positioning Air Cylinder into the Bracket

1. Place the valve assembly end of the air cylinder upon the short NSF foot plate (30) or on the protruding aluminum foot (standard model) on the base casting (1) and then tilt the air cylinder back until it rests against the back of the base casting.
2. Hold the top of the air cylinder in place, with one hand, while pushing inward on one of the clamp arms (5), with the other hand, until the cam (2) is engaged.
3. Push back on the actuating handle (12) until the top lip of the cam comes into contact with the lock screw (18). (See "To Obtain Correct Tension of the Air Cylinder" if the cam does not lock properly.)

**\*\*NOTE: The mechanical bracket is not to be used as a passive restraint when used with SCBA harness.**

# QUIC-HOLD® PULL RELEASE FOR MECHANICAL BRACKETS

## MODEL MWAB-PR

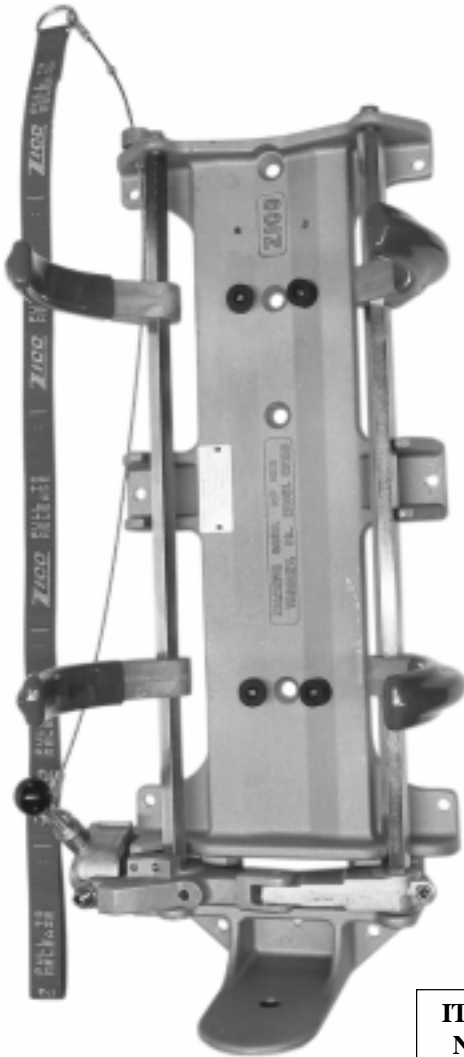

Pull release may be added to any model MWAB bracket except those ending in -SP.

Chart below lists the component parts.

Cable guide hole may have to be drilled and tapped if not present on your bracket. Attach Item 6 to right end of cable after inserting through hole in top of back plate. Then thread through hole in cam stud.

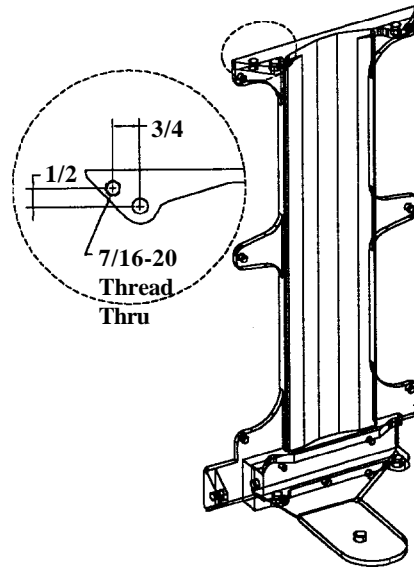

ITEM NO.	PART NUMBER	DESCRIPTION	QTY.
1	1045-250-104	3/32 SS Cable x 29-7/8" lg.	1
2	1045-250-101	Cable guide - 3/4 hex hd x 7/16-20 thread	1
3	1045-250-105	3/32 Single shank ball	1
4	3010-150-110	3/32 Compression sleeve	2
5	0000-000-120	Split ring key ring - 1" dia.	2
6	1045-225-113	Pull strap - 30" lg.	1

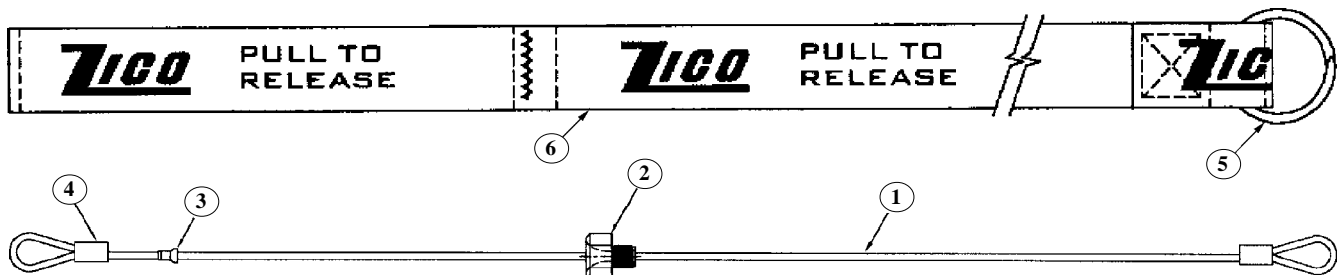



# QUIC-HOLD® PULL CABLE RELEASE FOR MWAB-\_\_-SP BRACKET, MODEL MWAB-PRC-\_\_



(L) Mounting position for cable (R)

Pull release cable may be mounted on either side of seat. Pull out on red knob to release clamp arms. Does not interfere with seat belts.

May only be used with the -SP style brackets, as shown. items 12 (1045-225-116) and 13 (1045-225-113) from -SP brackets (page 3) replaced by item 6 (1045-255-111) below.

ITEM NO.	PART NUMBER	DESCRIPTION	QTY.
1	{ 1045-255-101 1045-257-101 }	{ Control cable, left - 61" OAL Control cable, right - 51" OAL }	1
2	1045-255-103	Control cable bracket	1
3	1045-255-105	Positioning angle	1
4	1045-255-107	Cable housing clamp block	1
5	1045-255-109	Clamp block mounting plate	1
6	1045-255-111	Cam stud (modified from 1045-120-116)	1
7	1045-255-113	Cable end barrel	1
8	9010-102548	Screw, 1/4-20 x 3", hex head	2
9	9010-103116	Screw, 5/16-18 x 1", hex head	2
10	9010-102508	Screw, 1/4-20 x 1/2", hex head	2
11	9013-172500	Nut, 1/4-20 ESNA lock nut	4
12	9013-133100	Nut, 5/16-18 flex loc nut	2
13	9010-372504	Set screw, 1/4-20 x 1/4"	2
14*	1045-255-115	Control knob, red phenolic	2
15	9010-114316	Screw, 7/16-20 x 1" hex head	1
16	9014-204300	Lockwasher, split, 7/16" ID	1
17	9112-203700	Nut, jam, 3/8-18 hex head	1

\*Knob may be different from one shown

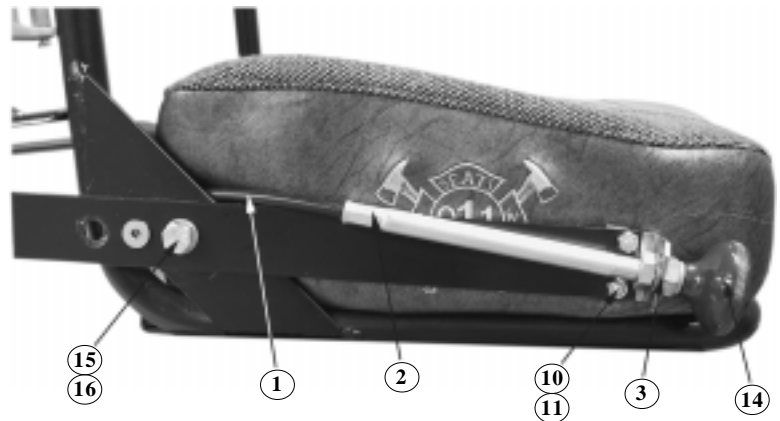
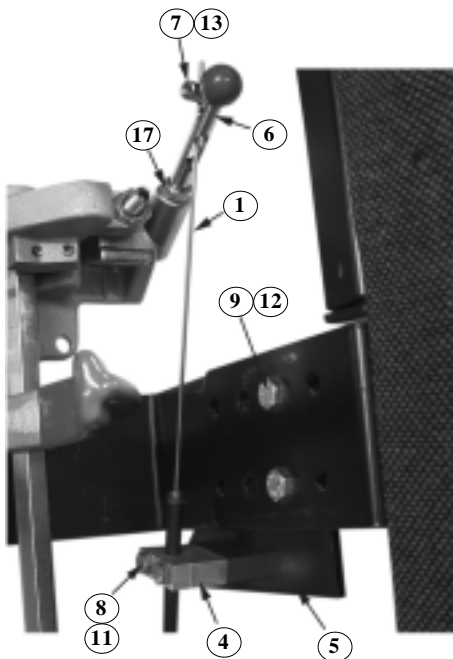

# INSTALLING THE PULL RELEASE CABLE (MWAB-PCR-\_) IN SEATS, INC. (911)/PIERCE SEATS EQUIPPED WITH THE MWAB-\_\_-SP MECHANICAL WALKAWAY® BRACKET

---

## Remove Operating Handle and replace with Cam Stud (6):

1. Remove the handle from the operating cam. On some styles there may be a 3/8-16 hex head jam nut holding the handle in place. If the jam nut is present, unloosen the nut and turn out the operating handle or cam stud. If there is no jam nut, simply unloosen the operating handle or cam stud.
2. Replace the operating handle with the new cam stud (6) and jam nut (17). Screw the handle in as far as it will go and then back out only as far as needed to position the elongated slot in a vertical direction and tighten the jam nut.

## Mount Cable Housing Clamp Block (4):

1. Remove the two 5/16 bolts holding the upper right side bracket to the seat frame and replace with 5/16-18 x 1" L bolts (9) supplied. Use this position to hold the mounting plate (5) to the outside face of the right side bracket and tighten.
2. Mount the cable housing clamp block (4) and tighten down until there is approximately a 1/16" gap between the blocks.

## Mount Control Cable Bracket (2):

1. Remove lower seat cushion and mount the control cable bracket (2) to the seat frame on the outer surface of either the left or right side of the seat and snug the bolt.

**NOTE: the -L cable (1) is 61" long and is mounted on the left side of the seat (facing the seat) and the -R cable (1) is 51" long and is for mounting on the right side of the seat.**

2. Mount the control cable (1) with positioning angle (3) attached to the outside of the control cable bracket (2), keeping the cable over the top of the control cable bracket and keeping the bolt heads on the inside. Tighten bolts.

## Feed Control Cable (1) to Cam Stud (6):

1. Feed the control cable (1) through the metal seat frame, inside the vertical tube and under the horizontal brace, then up through the clamp block (4) and then allow the cable, inside the tube, to go through the slot in the cam stud (6).
2. Allow approximately 1-1/2" of the cable tube to extend above the clamp block (4). Snug the bolts, but allow the clamp block to pivot. Move the cam stud (6) through its range of motion (full open to full close). Pivot the clamp block until you have the least interference with the cable and then tighten the clamp block bolts (8) (11).

## Adjust the Control Cable:

1. Reinstall the seat cushion. The control cable bracket (2) may be moved in or out and swung up or down to fit the application and then tightened down.
2. Push the cam up into the locked position. Push the control knob (14) all the way in. Slide the cable end barrel (7) down the cable until it is approximately 1/16" away from the cam stud (6) and tighten the set screws (13).

**NOTE: Using two hex keys works best.**

3. Check operation by pulling out of the control knob (14), which should move the cam to the open position and allow the air cylinder to be removed from the bracket. Cable may be returned to the locked position to keep the control knob from getting in the way.
4. After all the adjustments are made and the unit is working okay, we suggest bending over the end of the control cable to avoid a piercing hazard.

# RECOMMENDED MECHANICAL BRACKET BY SCBA MANUFACTURER

MANUFACTURER & CYLINDER COMP.		CYLINDER/ MODEL NO.	MINUTES DURATION	HIGH PRESS. PSI	LOW PRESS. PSI	RECOMMENDED BRACKET ORDER NO.	RECOMMENDED SEATS/PIERCE BRACKET ORDER NO.	RECOMMENDED BOSTROM BRACKET ORDER NO.
Cairns Air	AL	3100003-0111	30		2216	MWAB-03-7	MWAB-6-SP	MWAB-B-6
	HWFG	3100003-0112	30		2216	MWAB-03-7	MWAB-6-SP	MWAB-B-6
	FWFG	3100003-0113	30		2216	MWAB-03-7	MWAB-6-SP	MWAB-B-6
	FWFG	3100004-0111	30	4500		MWAB-03-5	MWAB-5-D-SP	MWAB-BD-5
	FWFG	3100004-0112	45	4500		MWAB-03-7	MWAB-6-SP	MWAB-B-6
	FWFG	3100004-0113	60	4500		MWAB-03-7	MWAB-7-SP	MWAB-B-7
	FWK/FG	3100004-0115	30	4500		MWAB-03-5	MWAB-5-D-SP	MWAB-BD-5
	FWK/FG	3100004-0116	45	4500		MWAB-03-7	MWAB-6-SP	MWAB-B-6
	FWK/FG	3100004-0117	60	4500		MWAB-03-7	MWAB-7-SP	MWAB-B-7
International Safety Instruments	HWFG	707.150.00						
		.024.035.00	30		2216	MWAB-03-7	MWAB-6-SP	MWAB-B-6
	AL	707.150.01						
		.024.037.00	30		2216	MWAB-03-7	MWAB-6-SP	MWAB-B-6
	FWFG	707.159.02						
		.024.086.00	30		2216	MWAB-03-7	MWAB-6-SP	MWAB-B-6
	FWFG	707.149.00						
		.024.065.00	60	4500		MWAB-03-7	MWAB-7-SP	MWAB-B-7
	FWFG	707.149.01						
		.024.066.00	30	4500		MWAB-03-5	MWAB-5-D-SP	MWAB-BD-5
	FWFG	707.149.00						
		.024.085.00	45	4500		MWAB-03-7	MWAB-6-SP	MWAB-B-6
Interspiro	HWFG	Spiromatic 4515						
		336-890-006	30		2216	MWAB-03-7	MWAB-6-SP	MWAB-B-6
	FWFG	Spiromatic 4530						
		336-890-003	30	4500		MWAB-03-5	MWAB-5-D-SP	MWAB-BD-5
	FWK	Spirolite 4530						
		336-890-177	30	4500		MWAB-03-5	MWAB-5-D-SP	MWAB-BD-5
	FWK	Spirolite 6630						
		336-890-177	45	4500		MWAB-03-7	MWAB-6-SP	MWAB-B-6
FWFG	Spiromatic 9030							
	336-890-037	60	4500		MWAB-03-7	MWAB-7-SP	MWAB-B-7	
FWK	Spirolite 9030							
	336-890-257	60	4500		MWAB-03-7	MWAB-7-SP	MWAB-B-7	
MSA Stealth	FWC	807586	30 L-30		2216	MWAB-03-7	MWAB-6-SP	MWAB-B-6
	FWC	807587	30 H-30	4500		MWAB-03-5	MWAB-5-D-SP	MWAB-BD-5
	FWC	807570	45 H-45	4500		MWAB-03-7	MWAB-6-SP	MWAB-B-6
	FWC	807588	60 H-60	4500		MWAB-03-7	MWAB-7-SP	MWAB-B-7
Composite II	FWFG	801279	30		2216	MWAB-03-7	MWAB-6-SP	MWAB-B-6
	FWFG	801287	30	4500		MWAB-03-5	MWAB-5-D-SP	MWAB-BD-5
	FWFG	801285	60	4500		MWAB-03-7	MWAB-7-SP	MWAB-B-7
Composite III	FWK	801289	30	3000		MWAB-03-5	MWAB-6-SP	MWAB-B-6
	FWK	806933	45	4500		MWAB-03-7	MWAB-6-SP	MWAB-B-6
	FWK	807002	60	4500		MWAB-03-7	MWAB-7-SP	MWAB-B-7
MSA	HWFG	469619	30		2216	MWAB-03-7	MWAB-6-SP	MWAB-B-6
	AL	809872	30		2216	MWAB-03-7	MWAB-6-SP	MWAB-B-6
	Steel	801281	30 3AL		2216	MWAB-03-7	MWAB-6-SP	MWAB-B-6

AL = aluminum      FWK/FG = full wrap Kevlar with fiberglass      FWFG = full wrap fiberglass  
 HWFG = hoop wrap fiberglass      FWK = full wrap Kevlar      FWC = full wrap carbon

**This chart may not be duplicated without written consent of Ziamatic Corp.**

# RECOMMENDED MECHANICAL BRACKET BY SCBA MANUFACTURER

MANUFACTURER & CYLINDER COMP.		CYLINDER/ MODEL NO.	MINUTES DURATION	HIGH PRESS. PSI	LOW PRESS. PSI	RECOMMENDED BRACKET ORDER NO.	RECOMMENDED SEATS/PIERCE BRACKET ORDER NO.	RECOMMENDED BOSTROM BRACKET ORDER NO.
National Drager	AL	Air Boss	30		2216	MWAB-03-7	MWAB-6-SP	MWAB-B-6
	HWFG	Air Boss	30		2216	MWAB-03-7	MWAB-6-SP	MWAB-B-6
	FWFG	Air Boss	30		2216	MWAB-03-7	MWAB-6-SP	MWAB-B-6
	FWFG	Air Boss	30	4500		MWAB-03-5	MWAB-5-D-SP	MWAB-BD-5
	FWFG	Air Boss	45	4500		MWAB-03-7	MWAB-6-SP	MWAB-B-6
	FWK	Air Boss	30	4500		MWAB-03-5	MWAB-5-D-SP	MWAB-BD-5
	FWK	Air Boss	45	4500		MWAB-03-7	MWAB-6-SP	MWAB-B-6
	FWK	Air Boss	60	4500		MWAB-03-7	MWAB-7-SP	MWAB-B-7
North Safety Products	AL	810	30	4500		MWAB-03-7	MWAB-6-SP	MWAB-B-6
	FWFG	811	60	4500		MWAB-03-7	MWAB-7-SP	MWAB-B-7
	AL	812	30		2216	MWAB-03-7	MWAB-6-SP	MWAB-B-6
	HWFG	816	30		2216	MWAB-03-7	MWAB-6-SP	MWAB-B-6
	HWFG	817	30	4500		MWAB-03-5	MWAB-5-D-SP	MWAB-BD-5
	FWFG	820	30	4500		MWAB-03-5	MWAB-5-D-SP	MWAB-BD-5
	FWFG	821	60	4500		MWAB-03-7	MWAB-7-SP	MWAB-B-7
	AL	822	30		2216	MWAB-03-7	MWAB-6-SP	MWAB-B-6
	HWFG	823	30		2216	MWAB-03-7	MWAB-6-SP	MWAB-B-6
	HWFG	824	30	4500		MWAB-03-5	MWAB-5-D-SP	MWAB-BD-5
O-Two Systems Lynx Air	AL	Standard 10LX1001	30		2216	MWAB-03-7	MWAB-6-SP	MWAB-B-6
	AL	NFPA 10LX2001	30		2216	MWAB-03-7	MWAB-6-SP	MWAB-B-6
	FWFG	Light Wt. 10LX1002	30		2216	MWAB-03-7	MWAB-6-SP	MWAB-B-6
	FWFG	Lt Wt NFPA 10LX2002	30		2216	MWAB-03-7	MWAB-6-SP	MWAB-B-6
Protech Respirators	AL	Pro Pack 2700-AL	30		2216	MWAB-03-7	MWAB-6-SP	MWAB-B-6
	FWFG	Pro Pack 2700-FW	30		2216	MWAB-03-7	MWAB-6-SP	MWAB-B-6
Racal	AL	2000-AL	30		2216	MWAB-03-7	MWAB-6-SP	MWAB-B-6
	HWFG	2000-HW	30		2216	MWAB-03-7	MWAB-6-SP	MWAB-B-6
	FWFG	2000-FW	30		2216	MWAB-03-7	MWAB-6-SP	MWAB-B-6
Respiratory Systems	AL	LifairL-30-IND-50 300323-111	30		2216	MWAB-03-7	MWAB-6-SP	MWAB-B-6
	FWFG	LifairL-30-IND-52 300323-112	30		2216	MWAB-03-7	MWAB-6-SP	MWAB-B-6
Scott NXG2® Next Generation	FWC	200131-01	30		2216	Not Available	Not Available	Not Available
	FWC	200128-01	30	4500		Not Available	Not Available	Not Available
	FWC	200129-01	45	4500		Not Available	Not Available	Not Available
	FWC	200130-01	60	4500		MWAB-6-SP	MWAB-6-SP	MWAB-6-SP

AL = aluminum      FWK/FG = full wrap Kevlar with fiberglass      FWFG = full wrap fiberglass  
 HWFG = hoop wrap fiberglass      FWK = full wrap Kevlar      FWC = full wrap carbon

**This chart may not be duplicated without written consent from Ziamatic Corp.**

# RECOMMENDED MECHANICAL BRACKET BY SCBA MANUFACTURER

MANUFACTURER & CYLINDER COMP.		CYLINDER/ MODEL NO.	MINUTES DURATION	HIGH PRESS. PSI	LOW PRESS. PSI	RECOMMENDED BRACKET ORDER NO.	RECOMMENDED SEATS/PIERCE BRACKET ORDER NO.	RECOMMENDED BOSTROM BRACKET ORDER NO.	
Scott Aviation Anniversary Pack	AL	804101-01	30		2216	MWAB-03-7	MWAB-6-SP	MWAB-B-6	
	HWFG	804102-01	30		2216	MWAB-03-7	MWAB-6-SP	MWAB-B-6	
	FWFG	804103-01	30		2216	MWAB-03-7	MWAB-6-SP	MWAB-B-6	
	FWK	804514-01	30		3000	MWAB-03-6	MWAB-6-SP	MWAB-B-6	
	FWC	804840-01	30		2216	MWAB-03-7	MWAB-6-SP	MWAB-B-6	
	FWFG	804105-01	30	4500		MWAB-03-5	MWAB-5-D-SP	MWAB-5-BD-5	
	FWK	804225-01	30	4500		MWAB-03-5	MWAB-5-D-SP	MWAB-5-BD-5	
	FWC	804721-01	30	4500		MWAB-03-5	MWAB-5-D-SP	MWAB-5-BD-5	
	FWFG	804106-01	45	4500		MWAB-03-7	MWAB-6-SP	MWAB-6	
	FWK	804255-01	45	4500		MWAB-7-SC-50	Not Available	Not Available	
	FWC	804722-01	45	4500		MWAB-03-6	MWAB-6-SP	MWAB-B-6	
	FWFG	804107-01	60	4500		MWAB-03-7	MWAB-7-SP	MWAB-B-7	
	FWK	804222-01	60	4500		MWAB-03-7	MWAB-7-SP	MWAB-B-7	
	FWC	804723-01	60	4500		MWAB-03-7	MWAB-7-D-SP	MWAB-B-7	
SurvivAir Sigma	AL	964212/964213	30		2216	MWAB-03-7	MWAB-6-SP	MWAB-B-6	
	HWFG	964202/964203	30		2216	MWAB-03-7	MWAB-6-SP	MWAB-B-6	
	HWFG	964002/964003	30	4500		MWAB-03-5	MWAB-5-D-SP	MWAB-BD-5	
	FWFG	964222/964223	30		2216	MWAB-03-7	MWAB-6-SP	MWAB-B-6	
	FWFG	964012/964013	30	4500		MWAB-03-5	MWAB-5-D-SP	MWAB-BD-5	
	FWFG	966002/966003	45	4500		MWAB-03-7	MWAB-6-SP	MWAB-B-6	
	FWFG	967002/967003	60	4500		MWAB-03-7	MWAB-7-SP	MWAB-B-7	
	FWK	964022/964023	30	4500		MWAB-03-5	MWAB-5-D-SP	MWAB-BD-5	
	FWK	966012/966013	45	4500		MWAB-03-7	MWAB-6-SP	MWAB-B-6	
	FWK	967012/967013	60	4500		MWAB-03-7	MWAB-7-SP	MWAB-B-7	
	Omega	HWFG	964301/964311	30	4500		MWAB-03-7	MWAB-6-SP	MWAB-B-6
		HWFG	964101/964111	30	4500		MWAB-03-5	MWAB-5-D-SP	MWAB-BD-5
		AL	964303/964313	30		2216	MWAB-03-7	MWAB-6-SP	MWAB-B-6
		FWFG	964305/964315	30		2216	MWAB-03-7	MWAB-6-SP	MWAB-B-6
FWFG		964103/964113	30	4500		MWAB-03-5	MWAB-5-D-SP	MWAB-BD-5	
FWFG		966101/966111	45	4500		MWAB-03-7	MWAB-6-SP	MWAB-B-6	
FWFG		967101/967111	60	4500		MWAB-03-7	MWAB-7-SP	MWAB-B-7	
FWK		964105/964115	30	4500		MWAB-03-5	MWAB-5-D-SP	MWAB-BD-5	
FWK		966103/966113	45	4500		MWAB-03-7	MWAB-6-SP	MWAB-B-6	
FWK		967103/967113	60	4500		MWAB-03-7	MWAB-7-SP	MWAB-B-7	
Mark II	HWFG	9842	30		2216	MWAB-03-7	MWAB-6-SP	MWAB-B-6	
	FWFG	9840	30	4500		MWAB-03-5	MWAB-5-D-SP	MWAB-BD-5	
Cylinders	FWFG	9870	60	4500		MWAB-03-7	MWAB-7-SP	MWAB-B-7	
	AL	915140	30		2216	MWAB-03-7	MWAB-6-SP	MWAB-B-6	
	HWFG	916103	30		2216	MWAB-03-7	MWAB-6-SP	MWAB-B-6	
	FWFG	915170	30		2216	MWAB-03-7	MWAB-6-SP	MWAB-B-6	
	FWK	917130	30		2216	MWAB-03-7	MWAB-6-SP	MWAB-B-6	
	HWFG	915165	30	4500		MWAB-03-5	MWAB-5-D-SP	MWAB-BD-5	
	FWFG	916173	30	4500		MWAB-03-5	MWAB-5-D-SP	MWAB-BD-5	
	FWK	916135	30	4500		MWAB-03-5	MWAB-5-D-SP	MWAB-BD-5	
	FWC	917131	30	4500		MWAB-03-5	MWAB-5-D-SP	MWAB-BD-5	
	FWFG	916140	30	4500		MWAB-03-7	MWAB-6-SP	MWAB-B-6	
	FWK	916145	45	4500		MWAB-03-7	MWAB-6-SP	MWAB-B-6	
	FWC	917145	45	4500		MWAB-03-7	MWAB-6-SP	MWAB-B-6	
	FWFG	915182	60	4500		MWAB-03-7	MWAB-7-SP	MWAB-B-7	
	FWK	915177	60	4500		MWAB-03-7	MWAB-7-SP	MWAB-B-7	
	FWC	917160	60	4500		MWAB-03-7	MWAB-7-SP	MWAB-B-7	

AL = aluminum      FWK/FG = full wrap Kevlar with fiberglass      FWFG = full wrap fiberglass  
 HWFG = hoop wrap fiberglass      FWK = full wrap Kevlar      FWC = full wrap carbon

**This chart may not be duplicated without written consent from Ziamatic Corp.**

(This page intentionally left blank.)

(This page intentionally left blank.)



*Ziamatic Corp.*

WWW.ZIAMATIC.COM

CALL TOLL FREE: 800-711-FIRE

10 West College Avenue, P.O. Box 337, Yardley, PA 19067-8337 • (215) 493-3618 • FAX: (215) 493-1401

\*ZICO is a registered trademark for fire, safety and marine products made by Ziamatic Corp.

Copyright Ziamatic Corp. 1-04