

## Spring Retractable, Hand Crank, Motor Driven Hose Reels

**Water** - 1/4", 3/8", 1/2" I.D.

- Compact design and quality steel construction
- The high pressure water swivel is designed to handle a broad range of pressures, temperatures, and chemicals
- Ideal for agricultural, marine, equipment cleaning, and pressure washing applications
- Individually powder coated components offer maximum protection from premature corrosion
- Models without hose are rated up to 5000 PSI
- Full flow swivel combines the highest grade seal design and materials with bearing areas to ensure maximum service life
- Available in hand crank, spring driven, or electric motor drive models



CT6100HN



PW7650 OHP



CA38106 M

Models with a ★ icon are our most popular models.

| Hose I.D.  | in mm       |     | in mm |    | in mm |     | Shipping Weight | Max Pressure | NPT(F) Reel Inlet | NPT(F) Reel Outlet | Size Index Page | Size Index # |     |     |
|--|-------------|-----|-------|----|-------|-----|-----------------|--------------|-------------------|--------------------|-----------------|--------------|-----|-----|
|  | 1/4         | 6   | 3/8   | 10 | 1/2   | 13  |                 |              |                   |                    |                 |              |     |     |
| Hose O.D.  | .530        | 13  | .730  | 19 | .850  | 22  |                 |              |                   |                    |                 |              |     |     |
| Model without hose   | Hose Length |     |       |    |       |     | lbs kg          | psi bar      | in                | in                 | Size Index Page | Size Index # |     |     |
|  | ft          | m   | ft    | m  | ft    | m   |                 |              |                   |                    |                 |              |     |     |
| <b>Manual Hand Crank Pressure Wash Reels</b> Maximum Temperature 210 °F (99 °C)      |             |     |       |    |       |     |                 |              |                   |                    |                 |              |     |     |
| CT6050HN   | ---         | --- | 50    | 15 | ---   | --- | 13              | 6            | 5000              | 345                | 1/2             | 3/8          | --- | 1   |
| CT6100HN   | ---         | --- | 100   | 30 | ---   | --- | 17              | 8            | 5000              | 345                | 1/2             | 3/8          | --- | 2   |
| CA38106 M  | 200         | 61  | 140   | 43 | 100   | 30  | 41              | 19           | 5000              | 345                | 1/2             | 1/2          | 25  | --- |
| CA38112 M  | 425         | 130 | 300   | 91 | 200   | 61  | 46              | 21           | 5000              | 345                | 1/2             | 1/2          | 25  | --- |
| <b>Electric Motor Driven Pressure Wash Reels</b> Maximum Temperature 212 °F (100 °C) |             |     |       |    |       |     |                 |              |                   |                    |                 |              |     |     |
| EA38106 M12D   | 200         | 61  | 140   | 43 | 100   | 30  | 63              | 29           | 5000              | 345                | 1/2             | 1/2          | 25  | --- |
| EA38112 M12D   | 425         | 130 | 300   | 91 | 200   | 61  | 71              | 32           | 5000              | 345                | 1/2             | 1/2          | 25  | --- |

PSI rating based upon 2.4 to 1 safety factor.

| Model with hose & bumper   | Shipping Weight |    | Hose I.D. |    | Hose O.D. |    | Hose Length |    | Max Pressure | NPT(M) Hose Outlet | NPT(F) Reel Inlet | NPT(F) Reel Outlet | Size Index Page | Size Index # |     |
|--|-----------------|----|-----------|----|-----------|----|-------------|----|--------------|--------------------|-------------------|--------------------|-----------------|--------------|-----|
|  | lbs             | kg | in        | mm | in        | mm | ft          | m  |              |                    |                   |                    |                 |              |     |
| <b>Spring Retractable Pressure Wash Reels</b> Maximum Temperature 210 °F (99 °C) |                 |    |           |    |           |    |             |    |              |                    |                   |                    |                 |              |     |
| PW7650 OHP ★   | 60              | 27 | 3/8       | 10 | .730      | 19 | 50          | 15 | 4800         | 331                | 1/4               | 1/2                | 3/8             | 12           | --- |
| PWD76075 OHP   | 90              | 41 | 3/8       | 10 | .730      | 19 | 75          |    | 4800         | 331                | 1/4               | 1/2                | 3/8             | 13           | 2   |
| PW81100 OHP  | 119             | 54 | 3/8       | 10 | .730      | 19 | 100         | 30 | 4800         | 331                | 3/8               | 1/2                | 3/8             | 14           | 1   |

PSI rating based upon 2.4 to 1 safety factor.

| Model without hose & bumper  | Shipping Weight |    | Hose Capacity |      |        | Max Pressure | NPT(F) Reel Inlet | NPT(F) Reel Outlet | Size Index Page | Size Index # |     |     |    |     |
|--|-----------------|----|---------------|------|--------|--------------|-------------------|--------------------|-----------------|--------------|-----|-----|----|-----|
|  | lbs             | kg | I.D.          | O.D. | Length |              |                   |                    |                 |              |     |     |    |     |
|  |                 |    | in            | mm   | in     | mm           | ft                | m                  | psi             | bar          | in  | in  |    |     |
| <b>Spring Retractable Pressure Wash Reels</b> Maximum Temperature 210 °F (99 °C) |                 |    |               |      |        |              |                   |                    |                 |              |     |     |    |     |
| PW7600 OHP   | 43              | 20 | 3/8           | 10   | .730   | 19           | 50                | 15                 | 5000            | 345          | 1/2 | 3/8 | 12 | --- |
| PW81000 OHP ★  | 86              | 39 | 3/8           | 10   | .730   | 19           | 100               | 30                 | 5000            | 345          | 1/2 | 3/8 | 14 | 1   |

PSI rating based upon 2.4 to 1 safety factor.

|          | 1                              |     | 2                              |     | 3                              |     |
|----------|--------------------------------|-----|--------------------------------|-----|--------------------------------|-----|
|          | in                             | mm  | in                             | mm  | in                             | mm  |
| <b>A</b> | 15 <sup>5</sup> / <sub>8</sub> | 397 | 15 <sup>5</sup> / <sub>8</sub> | 397 | 19 <sup>7</sup> / <sub>8</sub> | 505 |
| <b>B</b> | 13 <sup>1</sup> / <sub>4</sub> | 337 | 13 <sup>1</sup> / <sub>4</sub> | 337 | 16                             | 406 |
| <b>C</b> | 3 <sup>1</sup> / <sub>2</sub>  | 89  | 3 <sup>1</sup> / <sub>2</sub>  | 89  | 5                              | 127 |
| <b>D</b> | 4 <sup>1</sup> / <sub>4</sub>  | 108 | 4 <sup>1</sup> / <sub>4</sub>  | 108 | 6                              | 152 |
| <b>E</b> | 15 <sup>1</sup> / <sub>2</sub> | 394 | 19 <sup>1</sup> / <sub>2</sub> | 495 | 19 <sup>7</sup> / <sub>8</sub> | 505 |
| <b>F</b> | 6                              | 152 | 6                              | 152 | 6                              | 152 |

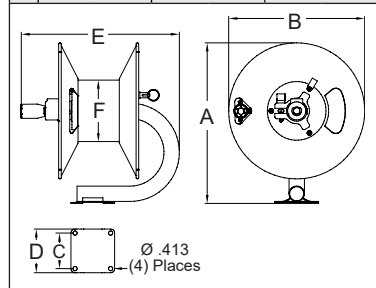

 **Interactive Reel Catalog**

Visit [reelcraft.com/catalog](http://reelcraft.com/catalog) for complete product specifications, parts, and accessories.

 **High Pressure Hose Assemblies & Bumper Stops**

See page 37