



Capacitive Sensors Series 90 - AC/DC

Housing $\varnothing = 26 \text{ mm} / 1'' / 40 \text{ mm}$

- Housing material PTFE
- SIP / CIP 121° C
- Sensing distance 0...15 mm adjustable
- With Triclamp process connection

Certificate:



Technical data	Non-flush mountable	Non-flush mountable
Operating distance S_n	5 mm	5 mm
Operating distance min./max. adjustable	0...15 mm	0...15 mm
Electrical version	2-wire AC/DC	2-wire AC/DC
Output	Normally open (NO)	Normally closed (NC)
Type	KAS-90-26-S-PTFE-Tri	KAS-90-26-Ö-PTFE-Tri
Art.-No.	KA 0684	KA 0683
Connection diagram No..	1	2
Operating voltage (U_B)	20...250 V AC/DC	20...250 V AC/DC
Output current max. (I_o)	250 mA	250 mA
Load current min.	5 mA	5 mA
Voltage drop max. (U_d)	$\leq 6.0 \text{ V}$	$\leq 6.0 \text{ V}$
Permitted residual ripple max.	-	-
No-load current (I_o)	Typ. 2.5 mA	Typ. 2.5 mA
Frequency of operating cycles max.	25 Hz	
Permitted ambient temperature	-25...+70° C / CIP 121° C (zero-current)	-25...+70° C / CIP 121° C (zero-current)
LED-display	Yellow	Yellow
Protective circuit	Built-in	Built-in
Degree of protection IEC 60529	IP 67	IP 67
Norm	EN 60947-5-2	EN 60947-5-2
Connection cable	2 m, PUR, 2 x 0.75 mm ²	2 m, PUR, 2 x 0.75 mm ²
Housing material	PTFE (FDA 21 CFR 177.1550)	PTFE (FDA 21 CFR 177.1550)
Active surface	PTFE (FDA 21 CFR 177.1550)	PTFE (FDA 21 CFR 177.1550)
Lid	PA/PPO	PA/PPO

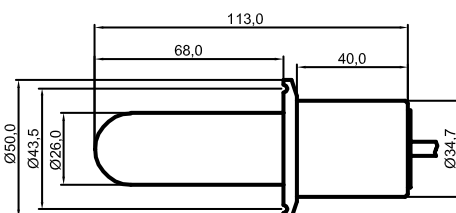

1

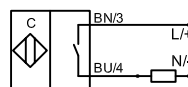

2

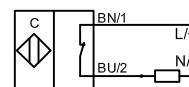

All specifications are subject to change without notice. (04.02.2009)

Made in Germany