



Capacitive Sensors

Series 80 - PNP

Housing M 30 x 1.5

- Housing material PTFE
- Sensing distance 1...30 mm adjustable
- With flange connector M 12 x 1

Certificate:



Technical data

Non-flush mountable

Operating distance S_n	15 mm
Operating distance min./max. adjustable	1...30 mm
Electrical version	4-pin DC
Output	Antivalent (NO + NC)
Type NPN	
Art.-No.	
Connection diagram No..	
Type PNP	KAS-80-A24/50-A-K-PTFE-Y5
Art.-No.	KA 0622
Connection diagram No.	6
Operating voltage (U_B)	10...35 V DC
Output current max. (I_o)	2 x 250 mA
Load current min.	-
Voltage drop max. (U_d)	≤ 2.0 V
Permitted residual ripple max.	10%
No-load current (I_o)	Typ. 15 mA
Frequency of operating cycles max.	50 Hz
Permitted ambient temperature	-25...+70° C
LED-display	Green/yellow
Protective circuit	Built-in
Degree of protection IEC 60529	IP 67
Norm	EN 60947-5-2
Connection	Flange connector M 12 x 1
Housing material	PTFE
Active surface	PTFE
Lid	PA/PPO

All specifications are subject to change without notice. (15.08.2007)

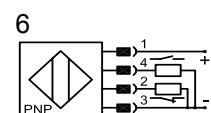
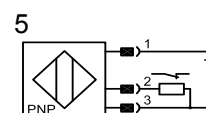
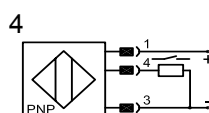
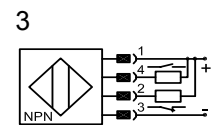
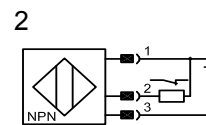
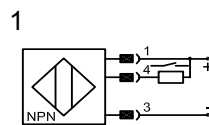
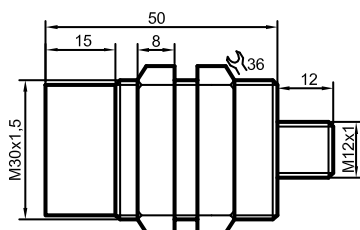

Made in Germany