

**MCD**

# 1.6 ALUCOFFRE

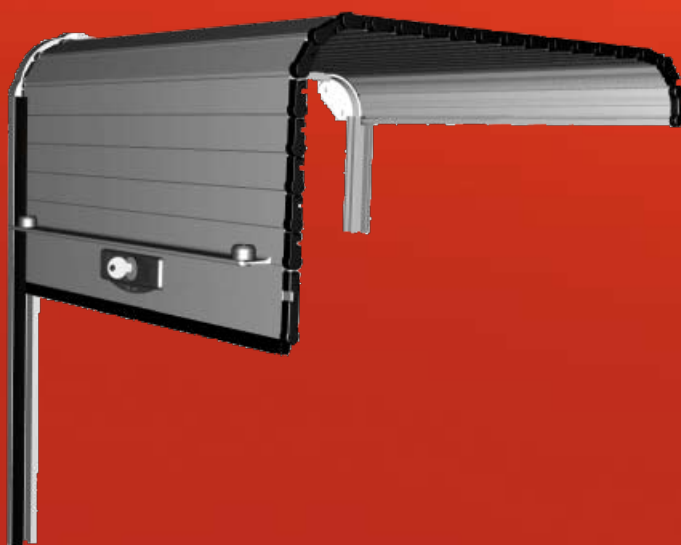

# ALUCOFFRE

## DESCRIPTION

The ALUCOFFRE door is made to measure with double-walled installable slats of extruded aluminium, each 30mm in height.

It is delivered in the form of separate parts ready to be installed.

- 1 assembled door
- 2 pair of aluminium rails ready to be fixed into position.
- 1 bag of accessories

The standard finish is in RAL 7035 satin finish powder coated grey, but the model can also be delivered in RAL 9010, anodized, mill or in other RAL.

Different kinds of closing systems and options compatible with ALUCOFFRE are available in the following chapters 3 and 4 of this documentation.



### WARNING

In contrast with other doors in the range, this model is not equipped with a roller assistance for manipulating. Therefore, the space needed in the upper part of the compartment (header) is reduced.

When the user opens an ALUCOFFRE, the shutter goes under the roof or under the roof and back if there is not enough space.

Consequently, it must be used only within the limits described in the board below.

Dimensions d'utilisation	
Maximum height	1000 mm
Maximum width	1000 mm
Minimum width	Following closing
Maximum area	0.5 m <sup>2</sup>
Door weight for 1 m <sup>2</sup>	12 kg

### Two kinds of track available

#### Standard track

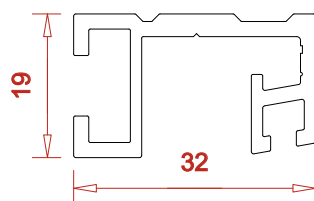

#### Overlapping track(\*)

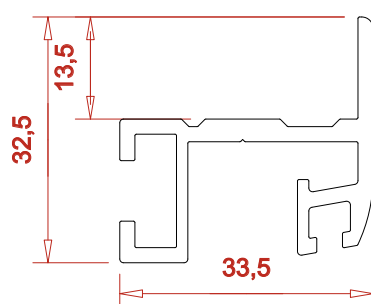

\* Warning : the header's thickness do not exceed 9 mm to use the overlapping track.

### Waterproof by 4 seals (Detail page 4.7.1)

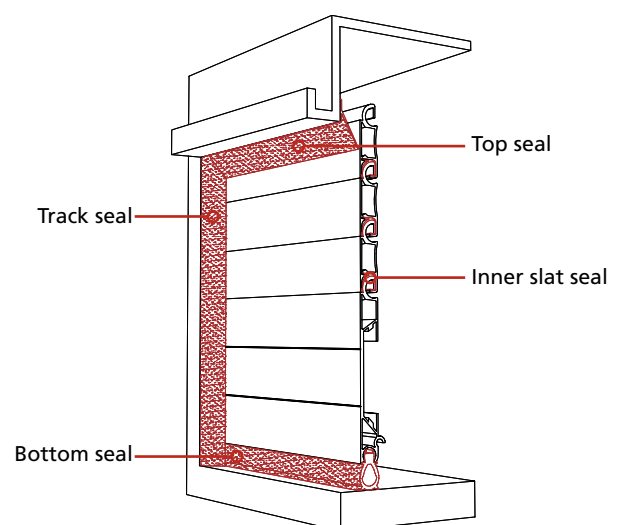

# SETTING UP

	Description
HI	Interior Height
HO	Opening Height
HP	Passing Height
L	Header
P	Depth
LP	Passing Width
LER	Total Width

### Formulae to remember:

$$HI = HO + L$$

$$HP = HO - 90 \text{ mm (handle with key)}$$

$$HP = HO - 50 \text{ mm (without key)}$$

$$L = 75 \text{ mm}$$

$$LP = LER - 50 \text{ mm}$$

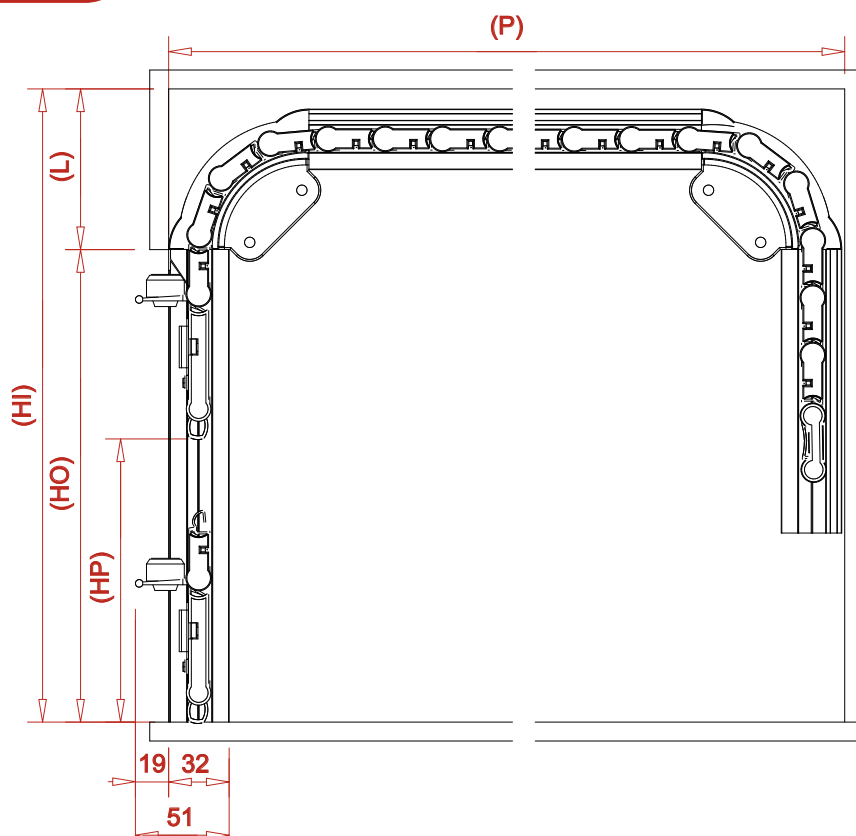

## Compatible closing systems with ALUCOFFRE

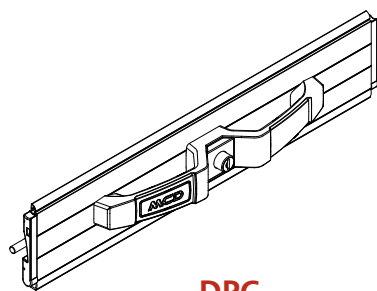

**DPC**  
Double handle with key  
(see page 3.1.1)

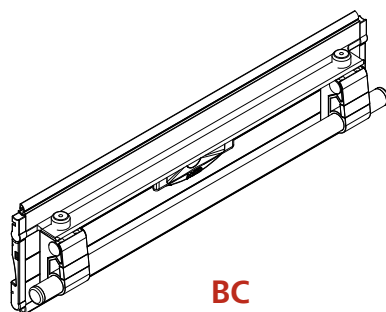

**BC**  
Bar lift handle with key  
(see page 3.2.1)

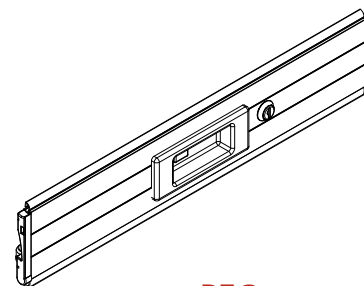

**PEC**  
Built-in handle with key  
(see page 3.3.1)

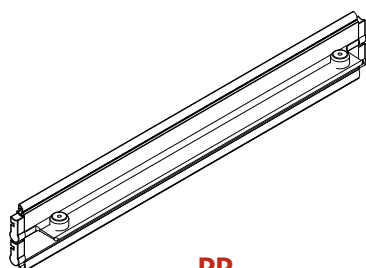

**PP**  
Profiled handle without key  
(see page 3.4.1)

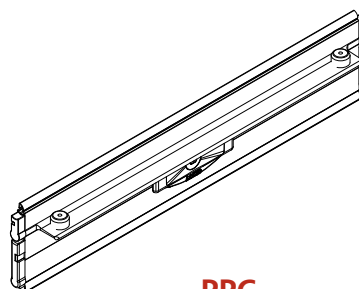

**PPC**  
Profiled handle with key  
(see page 3.4.1)

# EXPLODED VIEW ALUCOFFRE

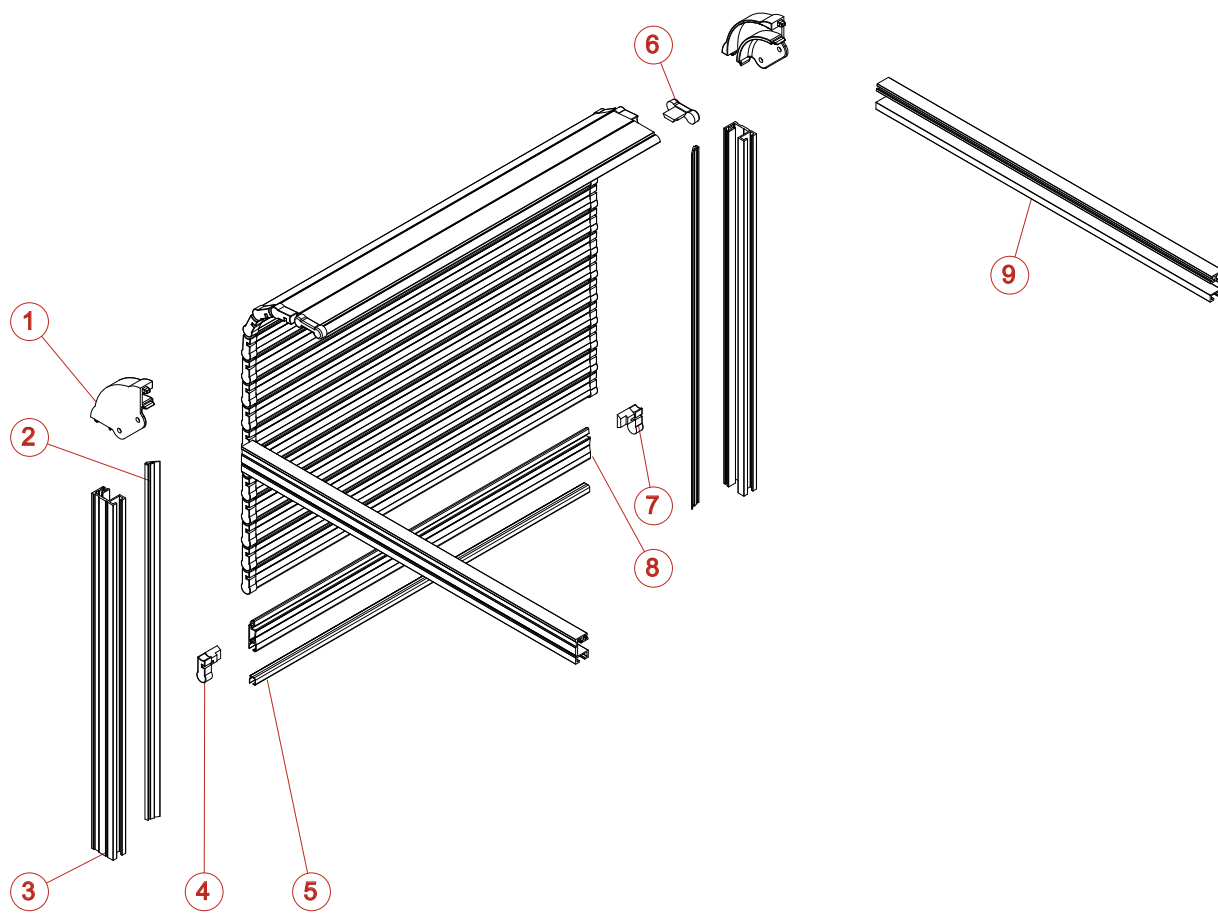

REP	CODE	DESCRIPTION
1	4300	90° PLASTIC CORNER
2	2023	TRACK SEAL (M)
3	1300	STANDARD TRACK (M)
4	4002	SLAT LEFT CAP
5	2004	INNER SLAT SEAL (M)
6	4004	SLAT SPECIAL CAP
7	4003	SLAT RIGHT CAP
8	1001	ABE SLAT 30 (M)
9	1300	STANDARD TRACK (M)

Elements list and exploded view for closing systems are introduced in the chapter 3 of this documentation.