

Foam Chamber & Foam pourer

Foam chamber

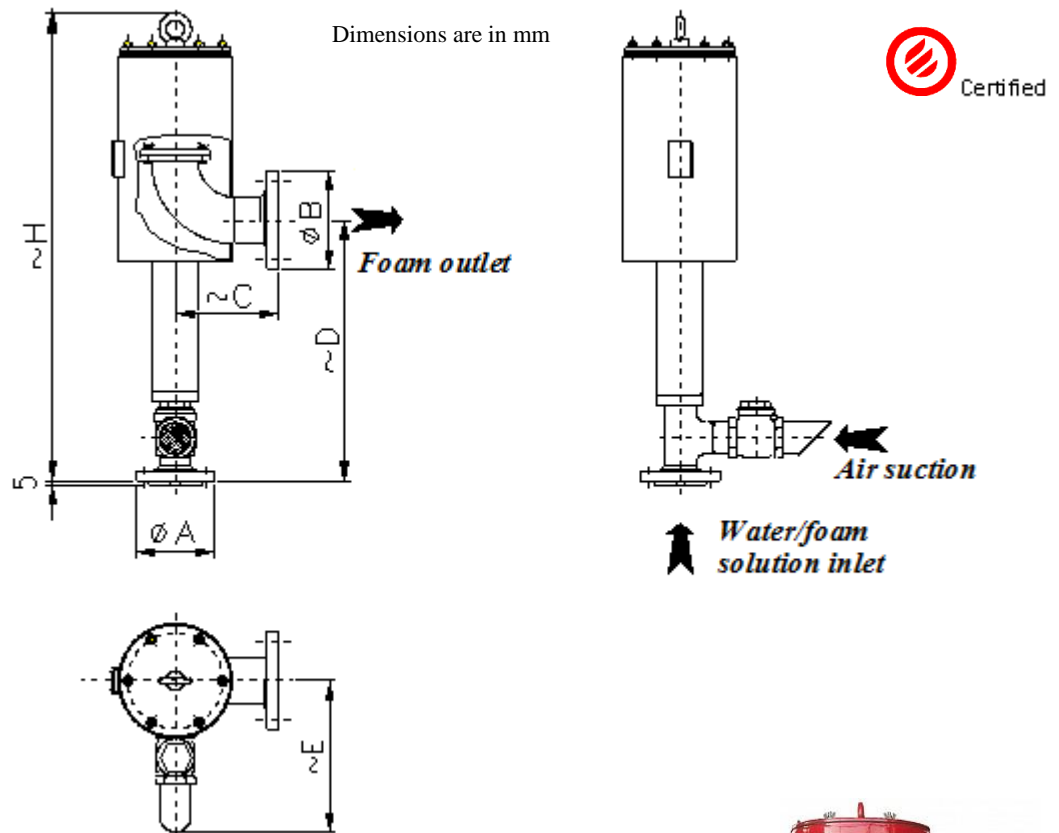

Construction features:

- Body material: carbon steel
- DIN or ANSI flanges material: carbon steel
- Rupture disc material: glass
- Detachable calibrated orifice material: stainless steel AISI 316
- Finish: red epoxy paint (RAL 3000)

Optional:

- Body material: stainless steel (AISI 304 / AISI 316)
- Flanges material: stainless steel (AISI 304 / AISI 316)
- Hot dip galvanized



Model	ØA	ØB	C mm	D mm	E mm	H mm	Working pressure bar	FLOW RATE l/min.-5bar	FOAM PRODUCTION ⁽¹⁾ ⁽²⁾ l/min. - 5 bar	Weight UNI (ANSI) Kg
C-2	2"	3"	200	500	265	845	3 ÷ 12	200	1500	32 (32)
C-4	2"	4"	200	500	295	845	3 ÷ 12	400	3000	34.6 (36)
C-8	3"	6"	300	600	355	1042	3 ÷ 12	800	6000	70.6 (72)
C-15	4"	8"	300	645	355	1081	3 ÷ 12	1500	11000	84.6 (90)
C-20	4"	8"/10"	400	855	385	1368	3 ÷ 12	2000	14000	123.6 (129.6)

⁽¹⁾ The foam production understands with fresh air, or different indication of foam producer.

⁽²⁾ Depending on foam concentrate type.

Foam pourer

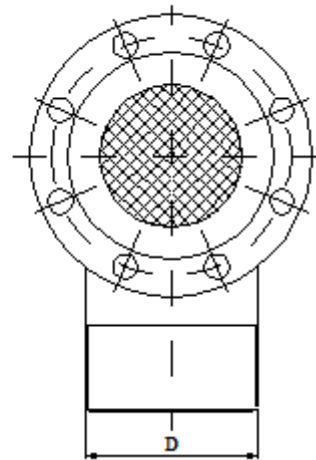
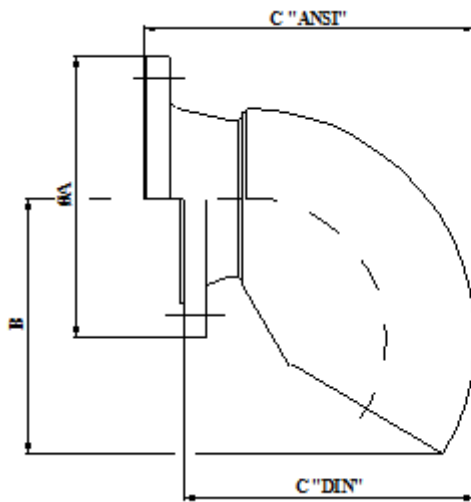

Construction features:

- Body material: carbon steel
- Flanges material: carbon steel
- Finish: red epoxy paint (RAL 3000)

Optional:

- Body material: stainless steel (AISI 304 / AISI 316)
- Strainer material: stainless steel AISI 316
- Flanges material: stainless steel (AISI 304 / AISI 316)
- Hot dip galvanized



MODEL	øA	B mm	C ANSI VERSION mm	C DIN VERSION mm	D mm	WEIGHT ANSI VERSION Kg	WEIGHT DIN VERSION Kg
D-2	3"	231	280	260	155	18	16.5
D-4	4"	231	286	262	155	18	16.5
D-8	6"	318	384	350	240	28	26.5
D-15	8"	318	397	357	240	37	36
D-20	8"/10"	426	508	475	350	37 - 54	36 - 53

Fixed roof protection – Foam chamber + Foam pourer

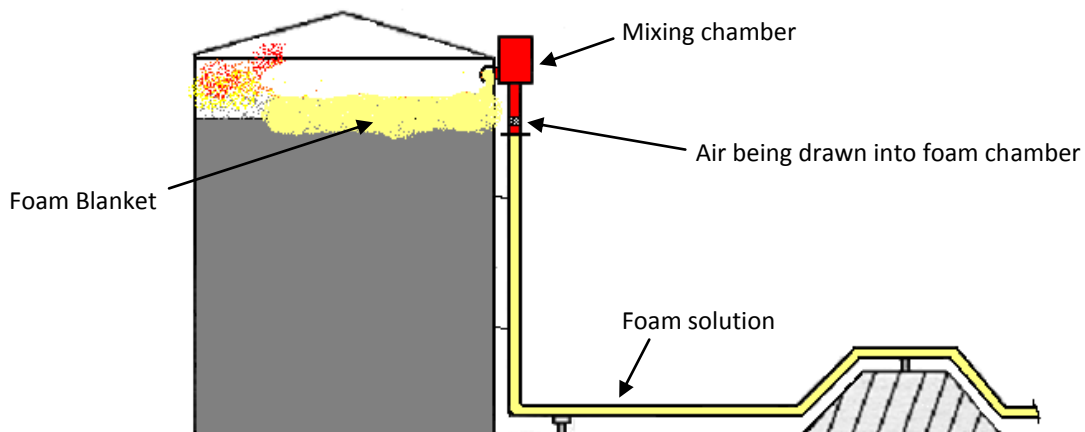
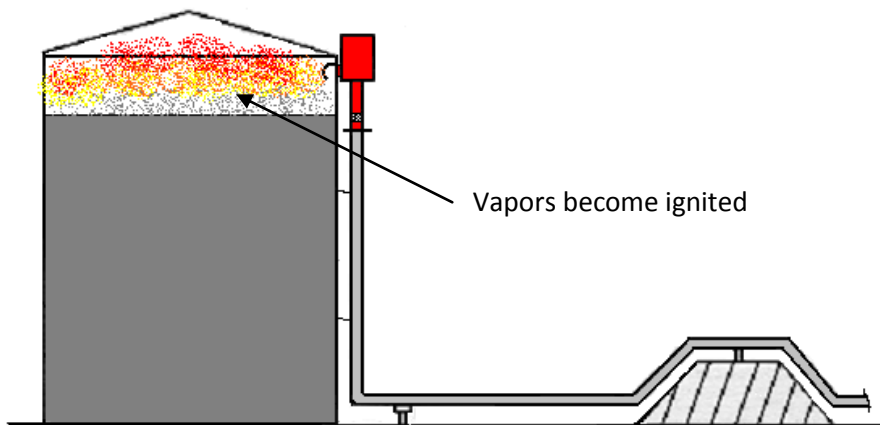
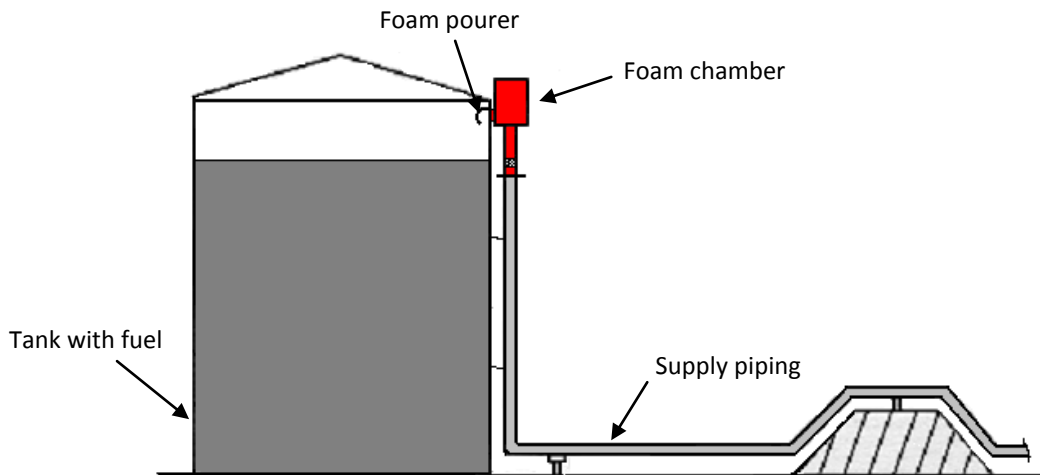

Foam solution is supplied to a "foam chamber". The foam chamber aerates the foam solution. The aerated foam is then agitated in the mixing chamber, creating a thick, durable foam blanket. Once the foam blanket covers the fuel surface, the fire will be extinguished