

**Rescue** equipment

**Holmatro**

**New Car Technology cutter**  
**CU 4055 C NCT™ II**



 **holmatro**  
mastering power

**An important trend** in vehicle design are the increasing dimensions and growingly complex constructions of A-, B- and C-pillars. Specially developed to surround these expanding constructions Holmatro's new CU 4055 C NCT™ II cutter has a blade opening of 202 mm, which is larger than ever. With a cutting capacity over 103 tons it is also the strongest rescue cutter in the Holmatro range. It has been tested on the most challenging 2008 car models and prototypes. Being part of our 4000-series this new cutter is equipped with many innovative features such as i-Bolt Technology, CORE™ Technology and LED lighting in the carrying handle.



Cross section of the A-pillar of a new Saab 9-3 convertible before and after cutting.



Complex and reinforced Volvo B-pillar cut by CU 4055 C NCT™ II.



Wide Volvo C-pillar cut by CU 4055 C NCT™ II.

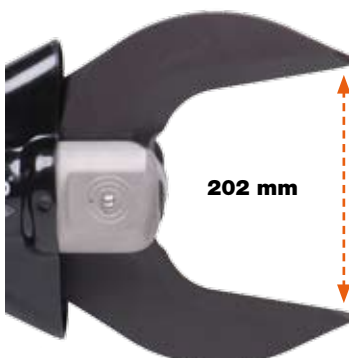

- U-shaped blades pull material into the cutting recess.
- Allows wide material to be cut at the strongest point of the cutter.



Holmatro New Car Technology Cutter CU 4055 C NCT™ II

**New Car Technology**

New developments in vehicle design, construction and materials follow each other swiftly and set increasingly higher demands on rescue tools. To anticipate these developments Holmatro stays in close contact with leading car manufacturers and the racing world. The result is a New Car Technology (NCT™) hydraulic cutter range, specially developed to deal with the high-strength materials and reinforced constructions used in modern cars. NCT™ II is the second generation of New Car Technology cutters, tested on the latest car models.

**NCT™ blade design**

Holmatro NCT™ blades are specifically designed to cut the advanced complex constructions and hard materials of A-, B-, C-pillars and sills in modern cars. Moreover, they do this with far more efficiency and at a much lower working pressure than possible with regular GP (General Purpose) blades. The characteristic U-shaped design of the NCT™ blades ensures that the material is pulled to the recess, where the cutting force is at its maximum. This results in an unparalleled superior cutting performance.

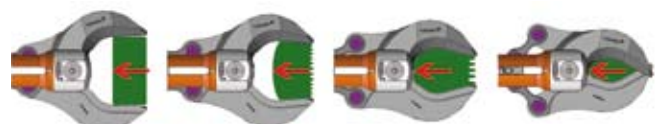
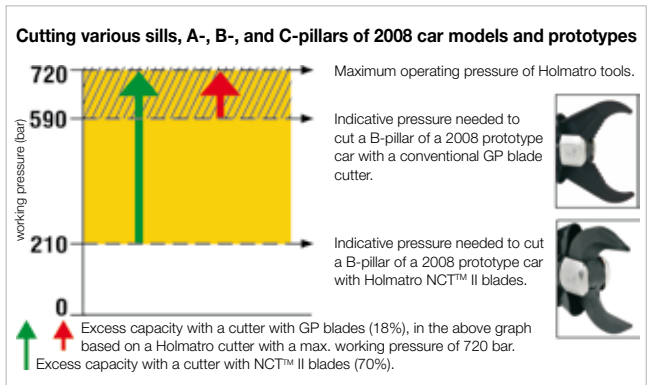



**Features & benefits**



- Large blade opening of 202 mm.
  - To surround the expanding A-, B- and C-pillars of modern cars.
- Tested on and suitable for the latest car models and prototypes.
- Superior cutting performance.
  - Latest NCT™ II blades.
  - Cutting force over 103 tons, strongest Holmatro cutter ever!
  - Cuts 41 mm round bar (material specification according to EN13204).
- i-Bolt Technology included.
  - Much flatter design for better access into narrow spaces.
  - Squeezes blades together more tightly, resulting in less blade separation and improved cutting performance.
  - Stainless steel cover protects bolt and blade holder.
- Equipped with CORE™ Technology.
  - Unique single hose / single coupler system.
  - Quicker, safer, easier.
  - Also available with dual hoses.
- LED lighting in carrying handle.
  - Never work in your own shadow again.
  - Have your own light source when rescue scene lighting is absent (e.g. in rapid intervention situations).
  - LEDs work appr. 6 hours on 1 standard AA battery.
  - Battery replaceable in less than 1 minute.



The CU 4055 C NCT™ II has been tested extensively on the wide A-, B- and C-pillars of the latest car models.



Large blade opening of 202 mm surrounds the widest C-pillars.

**Traditional bolt construction**

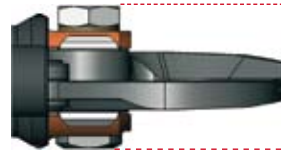

**New i-Bolt construction**

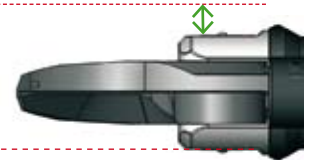

Flatter design for better access in tight places.

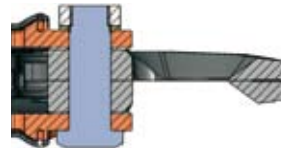

Squeezes ("softer" aluminium) blade holder. Blades are squeezed indirectly only.



Squeezes blades directly for a superior cutting performance.

**Specifications**



	<b>CU 4055 C NCT™ II</b>	<b>CU 4055 NCT™ II</b>
article number	150.012.166	150.012.167
equipped with	CORE™ Technology	dual hoses
max. working pressure bar/Mpa	720 / 72	720 / 72
blade opening mm	202	202
cutting force kN/t	1018 / 103.8	1018 / 103.8
round bar mm	41	41
weight ready for use kg	19.6	20.7
dimensions (L x W x H) mm	805 x 270 x 218	840 x 270 x 218
temperature range	-20° +55° C	-20° +55° C
required oil contents cc	163 (effective)	163 (effective)
EN 13204	CC202 H-19.6	CC202 H-20.7

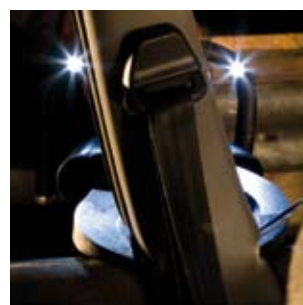

LED lighting in carrying handle.





**Holmatro N.V.**

World Headquarters  
Raamsdonksveer, The Netherlands



**Holmatro Rescue Equipment B.V.**

Raamsdonksveer, The Netherlands  
T +31 (0)162 58 92 00  
E info@holmatro.com  
Manufacturing, sales & service



**Holmatro, Inc.**

Glen Burnie, MD, U.S.A.  
Manufacturing, sales & service



**Holmatro China**

Shanghai, China  
Sales & service



**Holmatro Polska Sp. z o.o.**

Warsaw, Poland  
Manufacturing, sales & service

[www.holmatro.com](http://www.holmatro.com)

©Holmatro 1008.01 980.000.228

Disclaimer

While the greatest care has been devoted to the content, it is possible that the information in this printed matter is incorrect or incomplete. Holmatro N.V. and its affiliated companies (hereafter: Holmatro) cannot be held liable in any way for the consequences of activities undertaken on the basis of this printed matter. If you have any doubts about the correctness or completeness of the information, you shall contact Holmatro (phone number: +31 (0)162-589200).  
Nothing from this printed matter can be copied and/or made public in any way without the explicit authorisation of Holmatro.