

DATA SHEET

INLET FILTERS



**White Nylon
Models:**

7104, 7105, 7106, 7107, 7108

**Clear Nylon
Models:**

7104.4, 7105.5, 7106.6, 7107.7, 7108.8



Model 7106 and 7106.6 Shown

FEATURES

- Durable nylon body for corrosion resistance.
- Easily cleaned without removing filter or inlet plumbing.
- Flow from inside out so sediment collects inside filter.
- Optional mesh size and clear body available.

SPECIFICATIONS

	U.S.	Metric
7104 and 7104.4		
Suction Flow	6 gpm	23 lpm
Pressurized Flow	10 gpm	38 lpm
Inlet/Discharge Port	1/2" NPT(F)	1/2" NPT(F)
Weight	6 oz.	0.17 kg
Dimensions	3.6 x 2.95 x 5.35"	91.5 x 75 x 136 mm
7105 and 7105.5		
Suction Flow	15 gpm	57 lpm
Pressurized Flow	20 gpm	76 lpm
Inlet/Discharge Port	3/4" NPT(F)	3/4" NPT(F)
Weight	7 oz.	0.20 kg
Dimensions	3.6 x 2.95 x 5.35"	91.5 x 75 x 136 mm
7106 and 7106.6		
Suction Flow	20 gpm	76 lpm
Pressurized Flow	25 gpm	95 lpm
Inlet/Discharge Port	1" NPT(F)	1" NPT(F)
Weight	16 oz.	0.46 kg
Dimensions	5.0 x 4.1 x 6.35"	127 x 104 x 161 mm
7107 and 7107.7		
Suction Flow	35 gpm	133 lpm
Pressurized Flow	50 gpm	189 lpm
Inlet/Discharge Port	1-1/4" NPT(F)	1-1/4" NPT(F)
Weight	18 oz.	0.51 kg
Dimensions	5.0 x 4.1 x 7.0"	127 x 104 x 178 mm
7108 and 7108.8		
Suction Flow	60 gpm	227 lpm
Pressurized Flow	75 gpm	284 lpm
Inlet/Discharge Port	1-1/2" NPT(F)	1-1/2" NPT(F)
Weight	19 oz.	0.52 kg
Dimensions	5.13 x 4.1 x 8.13"	130 x 104 x 206.5 mm

COMMON SPECIFICATIONS

		U.S.	Metric
Mesh		80	80
Micron Equivalent		178	178
Inlet Pressure	@ 70° F	10 to 150 psi	.69 to 10.3 bar
	@ 125° F	10 to 100 psi	.69 to 6.9 bar
	@ 160° F	10 to 30 psi	.69 to 2.1 bar
Max Temperature		160° F	71° C

SELECTION

Select a filter appropriate for the flow and pumped liquid in your system. Typically the filter capacity should be two times the pump flow rate. Both white and clear bowls are available. A regular inspection will avoid problems. The clear bowl will immediately show a clogged screen.

INSTALLATION

An inlet filter is normally installed on the inlet side of the pump. The arrow molded in the filter cap indicates the direction of flow through the filter. A shut-off valve is recommended between the filter and liquid source for convenience when cleaning the filter.

OPERATION

Flow through the filter is from the inside out, collecting the sediment inside the filter. Regular checking and cleaning of the screen is suggested to avoid restricting the inlet flow to the pump.

MAINTENANCE

Flush screen regularly and reinstall into body. Check gasket for cuts or wear and replace if necessary to assure proper seal. Thread body and cap hand tight for proper seal.

EXPLODED VIEW

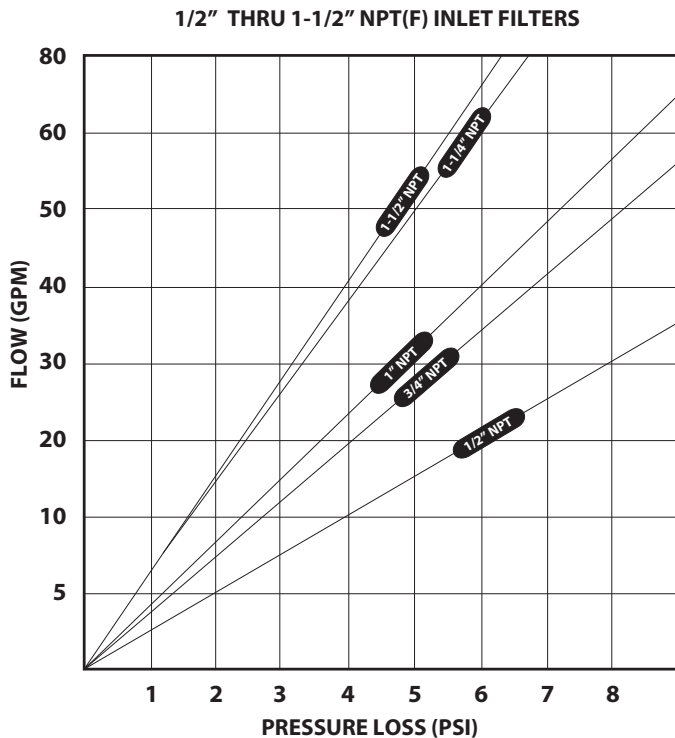
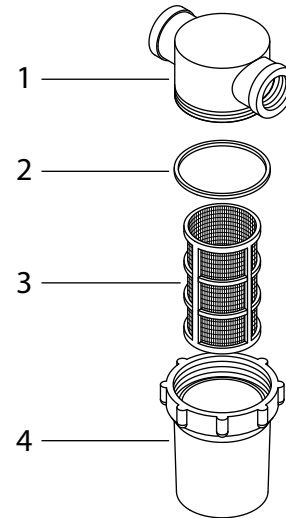

PARTS LIST

ITEM	P/N	MATL	DESCRIPTION	QTY
1	—	—	Body	1
2	33071	NBR	Gasket, 1/2", 3/4"	1
2	33073	NBR	Gasket, 1", 1-1/4", 1-1/2"	1
2	33082	FPM	Gasket, 1/2", 3/4"	1
2	33083	FPM	Gasket, 1", 1-1/4", 1-1/2"	1
3	33072*	S	Screen, 1/2", 3/4" 80 mesh	1
3	33074*	S	Screen, 1" 80 mesh	1
3	33075*	S	Screen, 1-1/4" 80 mesh	1
3	33076*	S	Screen, 1-1/2" 80 mesh	1
4	33077	NY	Bowl, clear, 1/2", 3/4"	1
4	33078	NY	Bowl, white, 1/2", 3/4"	1
4	33079	NY	Bowl, clear, 1", 1-1/4", 1-1/2"	1
4	33080	NY	Bowl, white, 1", 1-1/4", 1-1/2"	1

MATERIAL CODES (Not Part of Part Number): FPM=Fluorocarbon
 NBR=Medium Nitrile (Buna-N) NY=Nylon S=304SS
 Optional Mesh sizes available

*Complete assemblies and replacement screens for sizes 1/2", 3/4", 1", 1-1/4" and 1-1/2" will be supplied with a white plastic support cage.

⚠ CAUTIONS AND WARNINGS

All High Pressure Systems require a primary pressure regulating device (i.e. regulator, unloader) and a secondary pressure relief device (i.e. pop-off valve, relief valve). Failure to install such relief devices could result in personal injury or damage to pump or property. Cat Pumps does not assume any liability or responsibility for the operation of a customer's high pressure system.

Read all CAUTIONS and WARNINGS before commencing service or operation of any high pressure system. The CAUTIONS and WARNINGS are included in each service manual and with each Accessory Data sheet. CAUTIONS and WARNINGS can also be viewed online at www.catpumps.com/cautions-warnings or can be requested directly from Cat Pumps.

WARRANTY

View the Limited Warranty on-line at www.catpumps.com/warranty.